

DETAILED PLANS:

*CORNERSTONE MONTESSORI  
HALF STREET IMPROVEMENTS*

4910 SPRINGHILL RD  
BRYANT, ARKANSAS

PART OF THE NW ¼ OF THE NW ¼, SECTION  
16, TOWNSHIP 1 SOUTH, RANGE 14 WEST,  
SALINE COUNTY ARKANSAS

8-20-2025  
REV: 01/22/2026

PREPARED FOR:

STEPHEN NUCKOLS  
4910 SPRINGHILL RD  
BRYANT,AR

PRE-CONSTRUCTION COPY -

PLANS FOR BIDDING PURPOSES.  
QUANTITIES TO BE VERIFIED PRIOR  
TO CONSTRUCTION. CONTRACTOR  
TO VERIFY GRADES WITH ENGINEER  
PRIOR TO CONSTRUCTION.

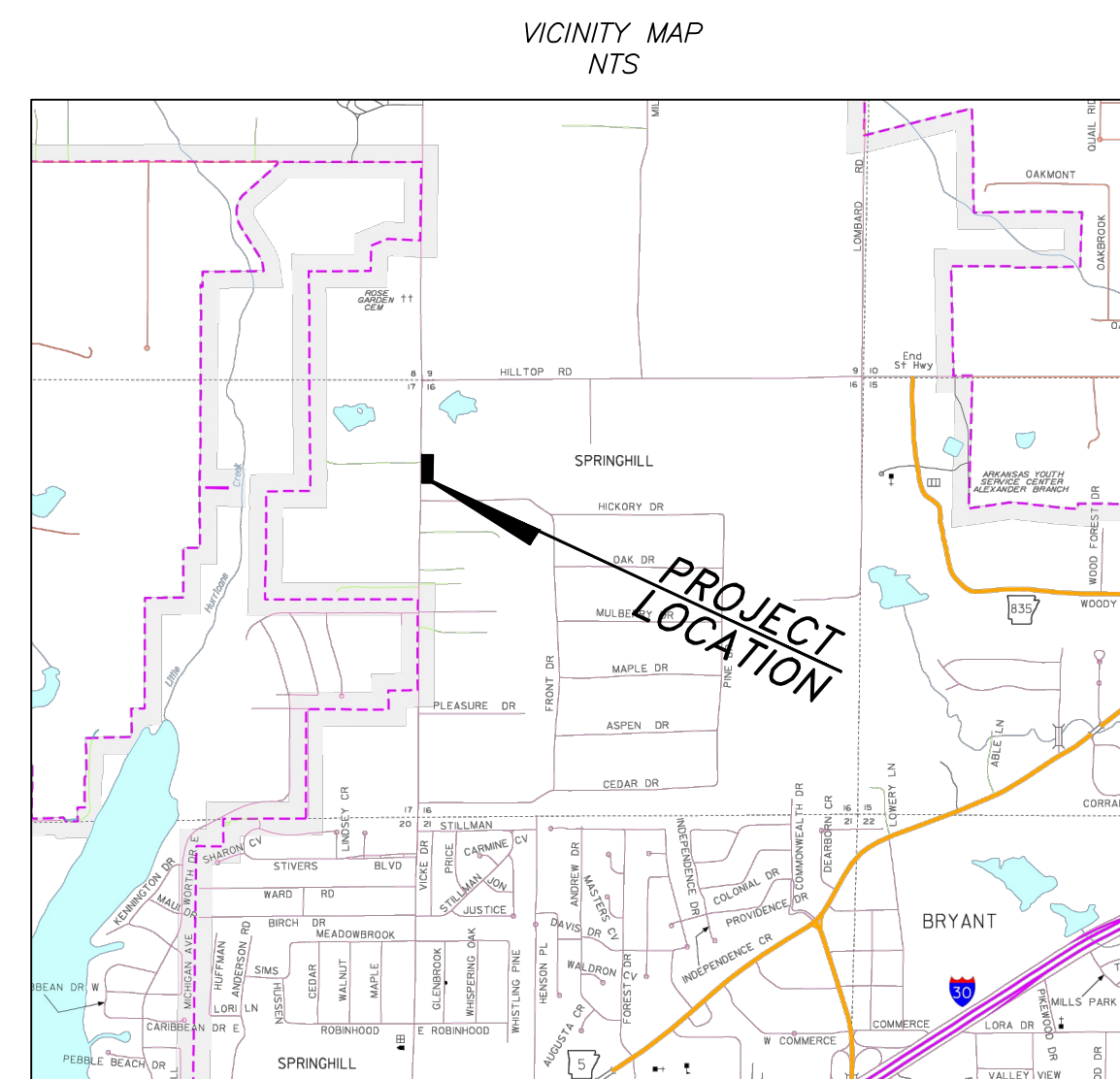

Prepared By:

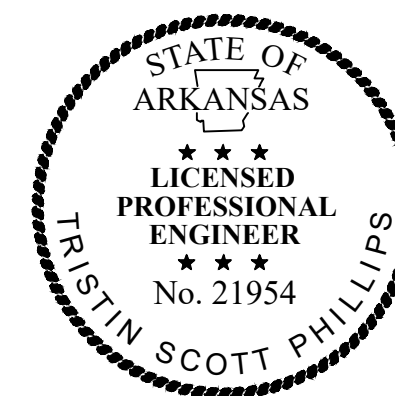

325 W. SOUTH STREET, BENTON, AR 72015 (501)315-7225

[illegible]

<i>INDEX OF SHEETS</i>	
<i>COVER SHEET</i>	<i>1</i>
<i>SWPPP</i>	<i>2</i>
<i>DEMOLITION PLAN</i>	<i>3</i>
<i>SITE PLAN/DIMENSION PLAN</i>	<i>4</i>
<i>UTILITY PLAN</i>	<i>5</i>
<i>GRADING PLAN</i>	<i>6</i>
<i>STORM DETIALS</i>	<i>7</i>



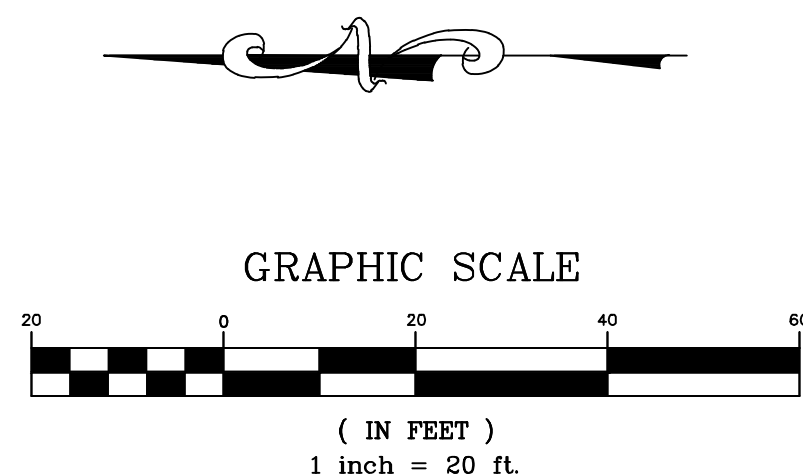
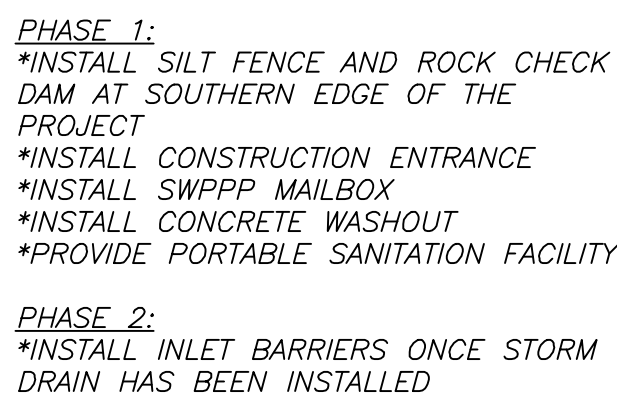

1. NOTES:
2. USE IN USE IN SMALL CHANNELS WITH DRAINAGE AREAS OF 50 ACRES OR LESS.
3. MUST BE USED IN CONJUNCTION WITH OTHER APPROPRIATE SEDIMENT CONTROL MEASURES.
4. USE BELOW CULVERT INSTALLATIONS, DAM CONSTRUCTION, OR ANY PROJECT THAT MAY INVOLVE GRADING ACTIVITY DIRECTLY IN A STREAM.
5. NOT INTENDED TO SUBSTANTIALLY IMPOUND WATER.
6. USE AT THE UPSTREAM END OF PONDS OR LAKES.
7. CHANNELS SHOULD NOT BE HIGHER THAN THE CHANNEL BANKS.
8. CENTER SHOULD BE AT LEAST 6 INCHES LOWER THAN THE OUTER EDGES OF THE DAM AT THE CHANNEL BANKS.
9. HEIGHT SHOULD NOT EXCEED ELEVATION OF UPSTREAM PROPERTY LINE.
10. SIDE SLOPES SHOULD BE 2:1 OR FLATTER.
11. TOP WIDTH SHOULD BE GREATER THAN 6 FEET.
12. EXTEND COMPLETELY ACROSS THE CHANNEL AND SECURELY TIE INTO BOTH CHANNEL BANKS
13. REQUIRES PERIODIC INSPECTION AND MAINTENANCE.
14. DUNE REMOVED WHEN IT REACHES OR EXCEEDS THE ORIGINAL DAM HEIGHT

1. THE LOCATION OF KNOWN SURFACE & SUBSURFACE STRUCTURES, PIPE, POWER, GAS, PHONE, ETC. ARE SHOWN ON THE PLANS. THE CONTRACTOR SHALL BE RESPONSIBLE FOR OBTAINING INFORMATION AND SATISFYING THEMSELVES AS TO THE LOCATION OF THE AFOREMENTIONED ITEMS, SHOWN AND NOT SHOWN. ALL REPAIRS OR RELOCATIONS NECESSARY SHALL BE MADE AS REQUIRED BY THE OWNER OF THE UTILITY OR STRUCTURE. THE COST OF SUCH REPAIRS OR RELOCATIONS NECESSARY SHALL BE BORNE BY THE CONTRACTOR.

3. EROSION CONTROL DEVICES SHALL BE INSTALLED AS THE PROJECT PROGRESSES AND AREAS ARE DISTURBED.

5. ALL INLETS ON AND ADJACENT TO THE SITE SHALL BE PROTECTED FROM SEDIMENT.

7. ALL EROSION CONTROL DEVICES ARE TO BE MAINTAINED IN GOOD WORKING CONDITION THROUGHOUT THE DURATION OF THIS PROJECT AND UNTIL PERMANENT VEGETATION IS ESTABLISHED. ALL SEDIMENT TRAPS ARE TO BE CLEANED AS REQUIRED.

9. REMOVE EROSION CONTROL DEVICES AFTER PERMANENT VEGETATION IS ESTABLISHED.

11. ADDITIONAL EROSION CONTROL MEASURES TO BE EMPLOYED WHERE NECESSARY BY SITE CONDITIONS.

15. CONTRACTOR IS RESPONSIBLE FOR COORDINATION OF TRAFFIC CONTROL WITH THE PROPER AUTHORITIES PRIOR TO CONSTRUCTION.

14. EROSION CONTROL PLAN SHALL BE MODIFIED SHOULD ANY CHANGE BECOME NECESSARY DURING CONSTRUCTION.

15. EROSION CONTROL MEASURES SHOWN ON THIS PLAN ARE NOT EXHAUSTIVE. OTHER EROSION CONTROL MEASURES AND BMP'S MAY BE REQUIRED TO PROVIDE ADEQUATE REDUCTION OF SOIL LOSS.

16. THE CURRENT SWPPP PERMIT AND EROSION CONTROL SITE PLAN SHALL BE KEPT ON SITE IN A DRY AND ACCESSIBLE LOCATION ON SITE SO THAT IT MAY BE INSPECTED BY CITY OF BRYANT AND ADEQ OFFICIALS.

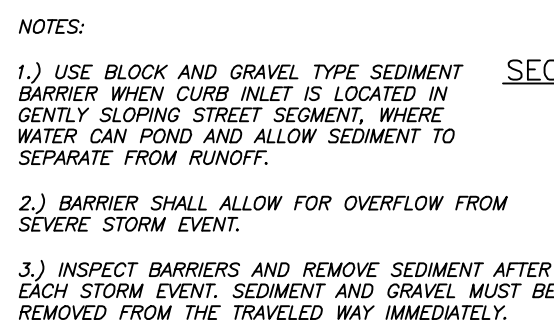
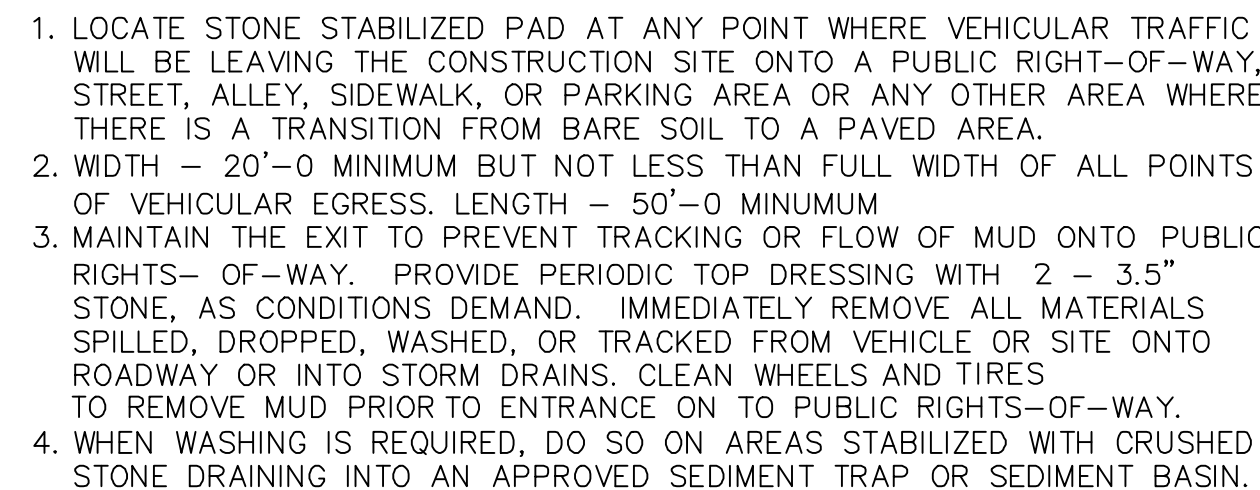

# CONSTRUCTION EXIT



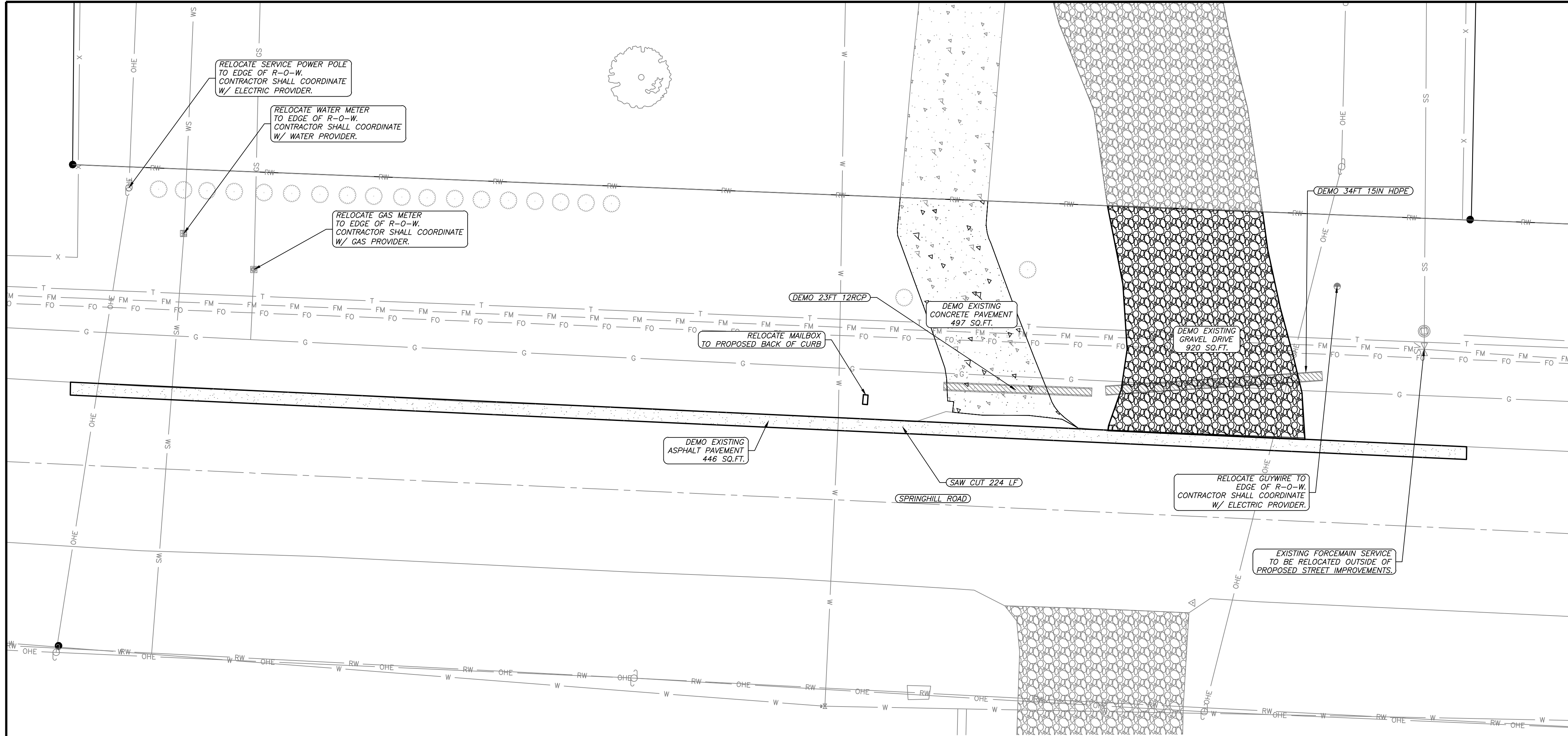

GENERAL CONSTRUCTION NOTES

- A. THE CONTRACTOR WILL BE HELD SOLELY RESPONSIBLE FOR DAMAGES OCCURRING TO ANY PROPERTY DURING THE CONSTRUCTION OF THIS PROJECT. SAID CONTRACTOR SHALL TAKE ALL NECESSARY PRECAUTIONS TO PREVENT PROPERTY DAMAGE.
- B. IN ACCORDANCE WITH GENERALLY ACCEPTED CONSTRUCTION PRACTICES, THE CONTRACTOR WILL SOLELY AND COMPLETELY BE RESPONSIBLE FOR CONDITIONS OF THE JOB SITE, INCLUDING SAFETY WORK. THIS REQUIREMENT WILL APPLY CONTINUOUSLY AND WILL NOT BE LIMITED TO NORMAL WORKING HOURS.
- C. ALL SITE AND UTILITY IMPROVEMENTS SHALL BE CONSTRUCTED IN ACCORDANCE WITH THE LATEST REVISION TO THE BRYANT UTILITIES STANDARD SPECIFICATIONS.
- D. THE APPROXIMATE LOCATION OF KNOWN SURFACE AND SUBSURFACE STRUCTURES, PIPES, POWER, GAS, PHONE, SERVICE CONNECTIONS, ETC. ARE SHOWN ON THE DESIGN DRAWINGS. THE CONTRACTOR SHALL BE RESPONSIBLE FOR DETERMINING THE EXACT LOCATION OF THE AFOREMENTIONED ITEMS, SHOWN AND NOT SHOWN.
- E. CONTRACTOR IS TO REMOVE AND DISPOSE OF ALL DEBRIS, RUBBISH, AND OTHER MATERIALS RESULTING FROM PREVIOUS AND CURRENT DEMOLITION OPERATIONS. DISPOSAL WILL BE IN ACCORDANCE WITH ALL LOCAL, STATE, AND/OR FEDERAL REGULATIONS GOVERNING SUCH OPERATIONS.
- F. PRIOR TO INSTALLATION OF ANY UTILITIES, THE CONTRACTOR IS TO EXCAVATE, VERIFY, AND CALCULATE ALL CROSSINGS AND INFORM ANY AND ALL UTILITIES OF ANY CONFLICTS PRIOR TO CONSTRUCTION.
- G. CONSTRUCTION SHALL NOT START ON ANY WATER UTILITY TIE-INS UNTIL APPROVAL IS GIVEN BY CITY OF BRYANT. SAID CONTRACTOR SHALL NOT OPERATE ANY VALVE, HYDRANT, OR WATER UTILITY APPURTENANCE NOR SHALL HE ATTACH TO OR TAP ANY WATER UTILITY MAIN WITHOUT APPROVAL. THE CONTRACTOR SHALL BEAR THE COST AND CONSEQUENCE OF ANY DISRUPTION OF UTILITY OPERATION CAUSED BY CONSTRUCTION.
- H. FIBER OPTIC CABLE ON AND/OR ADJACENT TO THIS SITE WERE NOT LOCATED BY THE SURVEY AND ARE NOT SHOWN. IT IS THE RESPONSIBILITY OF THE CONTRACTOR TO LOCATE ANY FIBER OPTIC CABLES ASSOCIATED WITH THIS SITE AND TAKE ALL NECESSARY AND REQUIRED PRECAUTIONS TO PROTECT ANY EXISTING FIBER OPTIC CABLES. CONTRACTORS SHALL COORDINATE ALL EFFORTS WITH OWNER OF FIBER OPTIC CABLES OR THEIR DESIGNATED REPRESENTATIVE.
- I. THE CONTRACTOR IS RESPONSIBLE FOR CONTACTING "ONECALL" SERVICE TO MARK ALL UTILITIES PRIOR TO ANY DEMOLITION, EARTHWORK, OR UTILITY WORK ON THIS SITE.
- J. CONTRACTOR TO COMPLY WITH ALL OSHA SAFETY REQUIREMENTS.
- K. CONTRACTOR IS RESPONSIBLE FOR COORDINATING TRAFFIC CONTROL WITH THE PROPER AUTHORITIES PRIOR TO CONSTRUCTION.



Know what's below.  
Call before you dig.

DEMO NOTES:  
1) QUANTITATIVE AREAS ARE APPROXIMATE, TO BE VERIFIED BY THE DEMOLITION CONTRACTOR.

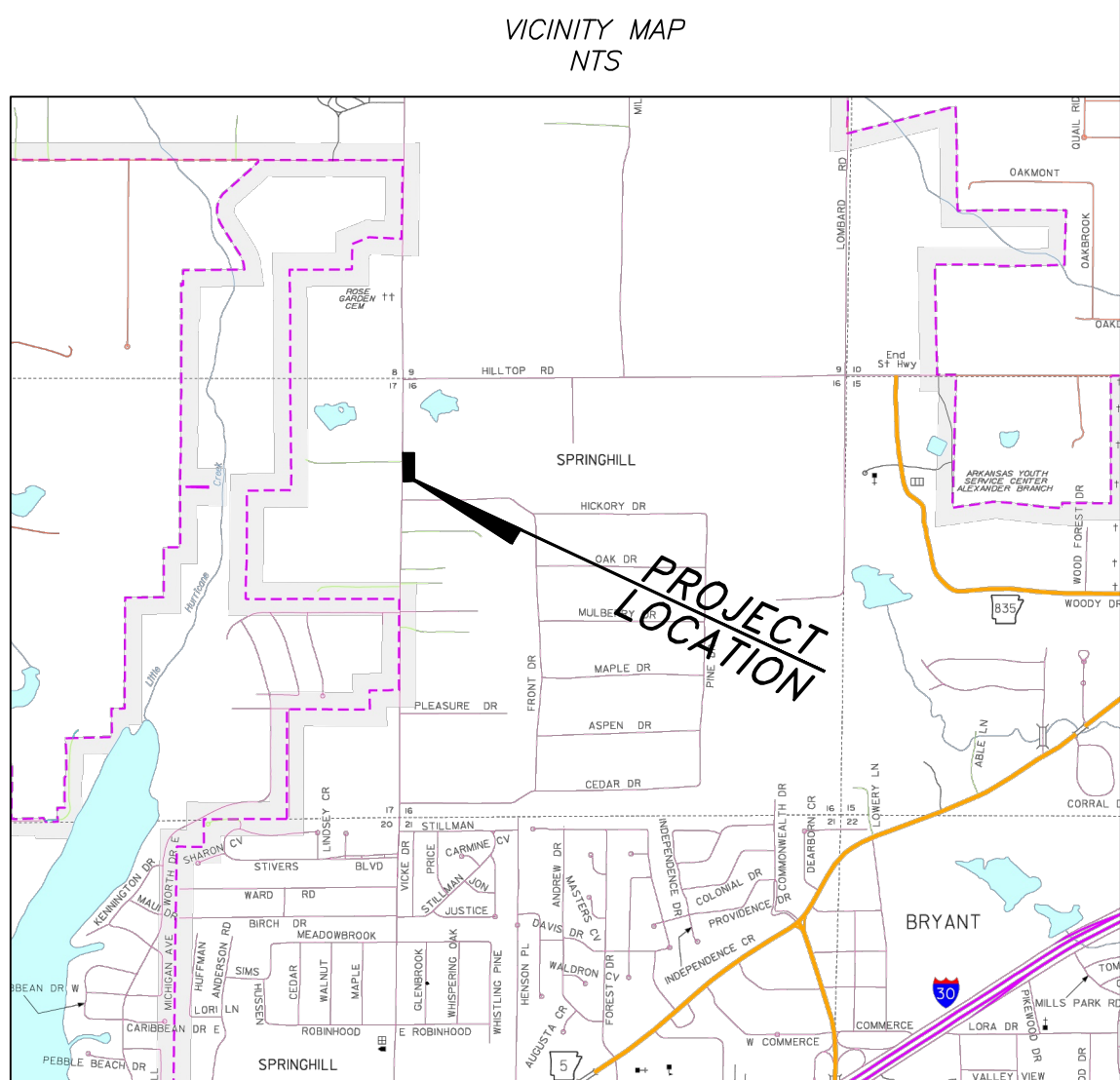
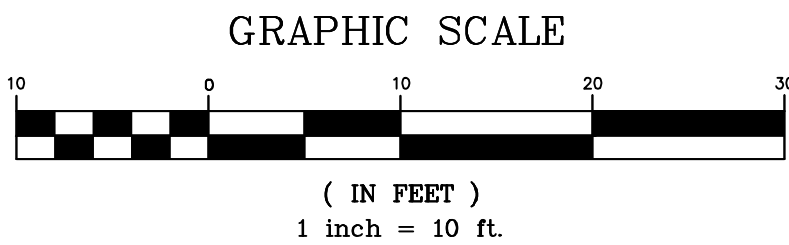

Legend	
	RW Right of Way
	Property Boundary
	Telephone
	Fiber Optic Line
	Road Center line
	Wire / Chainlink Fence
	Gas Line
	Gas Service Line
	Sanitary Sewer Service
	Force Main
	Water Line
	Water Service Line
	Overhead Powerline
	Water Meter
	Sanitary Sewer Manhole
	Storm Sewer Manhole
	Telephone Pedestal
	Force Main Gate Valve
	Sewer Service Check Valve
	Guy Wire
	Computed Corner
	Found Monument (Labeled)
	Utility Pole
	PROPOSED CONTOUR
	EXISTING CONTOUR

**RICHARDSON ENGINEERING**  
Planning • Engineering • Development Consulting  
325 W. SOUTH STREET, BENTON, AR 72015 (501)315-7225

DEMOLITION PLAN  
CORNERSTONE MONTESSORI HALF  
STREET IMPROVEMENTS  
4910 SPRINGHILL RD  
BRYANT, ARKANSAS

Prepared For:  
**STEPHEN NUCKOLS**  
4910 SPRINGHILL RD  
BRYANT, AR

No.	Date	Revisions
1	12/28/2023	FORCEMAIN REDROUTE

PROJECT #: 025-026  
Scale: 1" = 10'  
Date: 8-20-2025  
REV: 01/22/2026

Sheet: 3 of 7



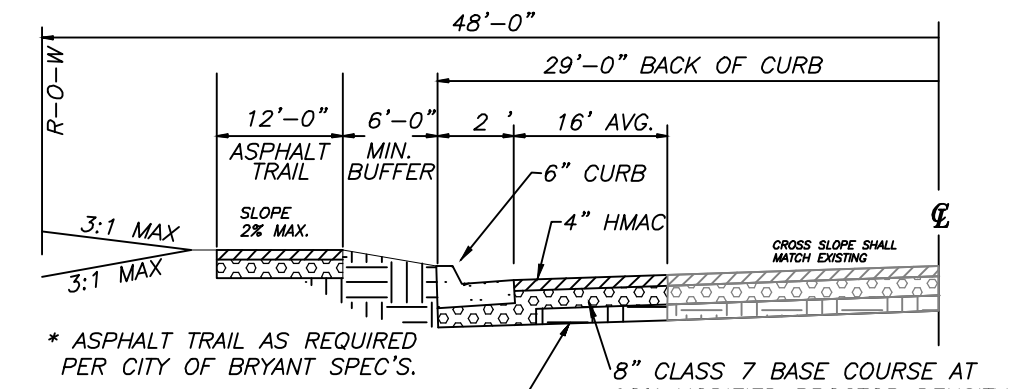
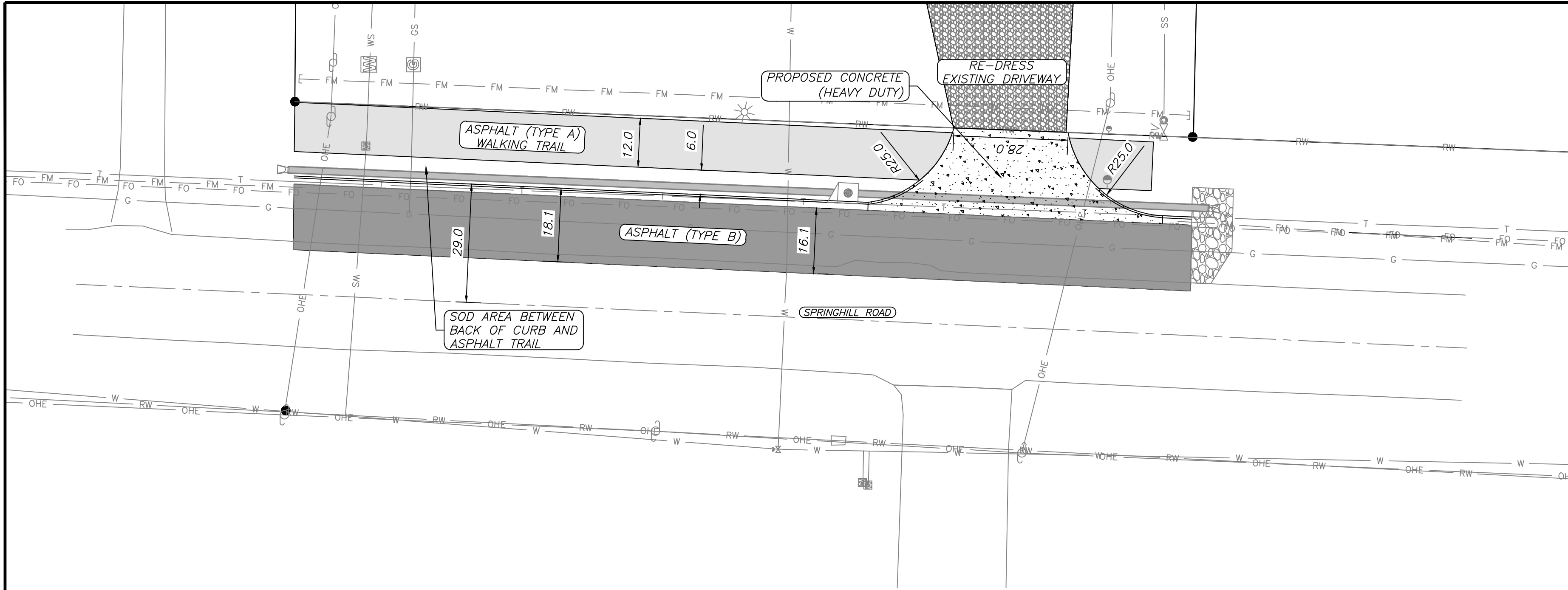

COMPACTED SUBGRADE AT 95% MODIFIED PROCTOR DENSITY (PAVEMENT SECTION TO MEET GEOTECHNICAL ENGINEER'S SPECIFICATIONS)

TYPICAL ROAD CROSS SECTION (HALF STREET) N.T.S.

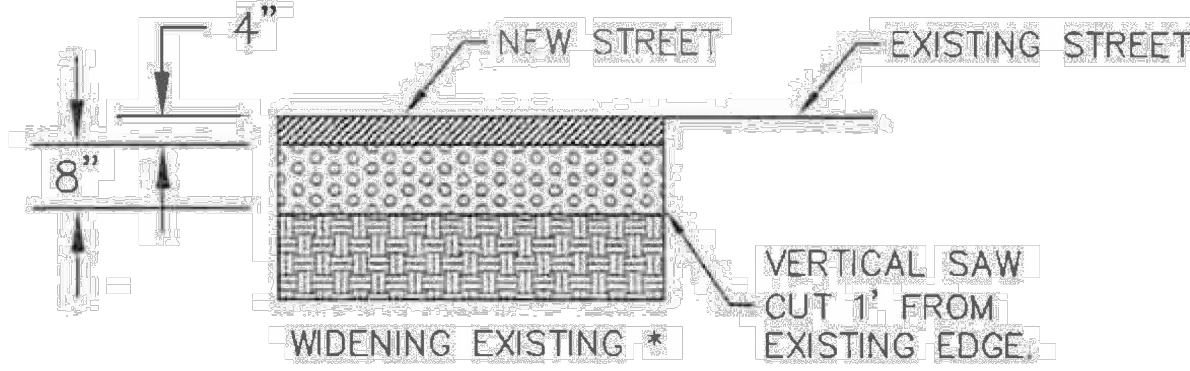

GENERAL NOTES

- IN AREAS TO RECEIVE BITUMINOUS PAVING, CONCRETE DRIVEWAYS OR CURB AND GUTTER, SUBGRADE SHALL BE COMPACTED TO A DENSITY NOT LESS THAN 95% OF MAXIMUM MODIFIED DENSITY OBTAINED AT OPTIMUM MOISTURE CONTENT.
- FOR AREAS OF SUBGRADE PREPARATION TO RECEIVE CONCRETE SIDEWALKS, SUBGRADE SHALL BE COMPACTED TO DENSITY OF 90% MAXIMUM MODIFIED DENSITY.
- CRUSHED STONE - MATERIAL IN EACH COURSE SHALL BE COMPACTED TO A DENSITY OF 98% MAXIMUM MODIFIED DENSITY.

PROPERTY DESCRIPTION AS SURVEYED

LOT 2 OF NUCKOLS ESTATES. A SUBDIVISION, IN THE CITY OF BRYANT, SALINE COUNTY, ARKANSAS. PLAT BOOK/PAGE 2021/020486.

LEGAL DESCRIPTION OF NUCKOLS ESTATES

PART OF THE NORTHWEST QUARTER OF THE NORTHWEST QUARTER, SECTION 16, TOWNSHIP 1 SOUTH, RANGE 14 WEST, DESCRIBED AS FOLLOWS: COMMENCING AT THE NORTHWEST CORNER OF SAID NORTHWEST QUARTER OF THE NORTHWEST QUARTER, THENCE S2°15'35"W ALONG WEST LINE OF SAID NORTHWEST QUARTER, A DISTANCE OF 819.14 FEET TO THE POINT OF BEGINNING; THENCE S89°26'33"E, A DISTANCE OF 353.66 FEET TO A FOUND IRON PIN AT THE SOUTHEAST CORNER OF LAND DESCRIBED IN INSTRUMENT #2017-006510 FILED IN SALINE COUNTY, ARKANSAS; THENCE ALONG THE SOUTH PROPERTY LINE OF LAND DESCRIBED IN INSTRUMENT #2009-57630 FILED IN SALINE COUNTY, ARKANSAS, S89°23'57"E, A DISTANCE OF 967.93 FEET TO A 3/8" FOUND IRON PIN WITH CAP #128 ON THE WEST PROPERTY LINE OF LANDS OWNED BY RONNY BROADWAY DESCRIBED IN INSTRUMENT #2020-017777 FILED IN SALINE COUNTY, ARKANSAS; THENCE LEAVING SAID SOUTH LINE ALONG THE WEST LINE OF BROADWAY, S03°06'57"W, A DISTANCE OF 494.53 FEET TO A 3/8" REBAR AND THE NORTH LINE OF LANDS DESCRIBED IN SALINE COUNTY DOCUMENT #2012-36651; THENCE N89°23'43"W, A DISTANCE OF 1313.94 FEET ALONG THE NORTH LINE OF LANDS OWNED BY BALISTERRI, WOOTEN AND VAUGH; THENCE N02°15'55"E, A DISTANCE OF 493.91 FEET TO THE POINT OF BEGINNING, CONTAINING 14.71 ACRES, MORE OR LESS.

GENERAL NOTES:

- PAVEMENT SHALL BE CONSTRUCTED IN ACCORDANCE WITH THIS PLAN AND BASED ON GEOTECHNICAL ANALYSIS OF THE SOIL CONDITIONS.
- ATTENTION IS CALLED TO CONSTRUCTION DETAILS FOR ADDITIONAL INFORMATION.
- CONSTRUCTION SITE SHALL ADHERE TO BRYANT STORMWATER REQUIREMENTS, AND SHALL MEET ALL APPLICABLE ADEQ STANDARDS FOR EROSION CONTROL MEASURES.
- ALL UTILITIES TO BE LOCATED PRIOR TO CONSTRUCTION (ONE CALL, CITY, ETC.)
- CONTRACTOR TO ADHERE TO CURRENT OSHA REGULATIONS INCLUDING EXCAVATION & TRENCH SAFETY.
- THE APPROXIMATE LOCATION OF KNOWN SURFACE AND SUBSURFACE STRUCTURES, PIPES, POWER, GAS, PHONE, ETC. ARE SHOWN ON THE DESIGN DRAWINGS. THE CONTRACTOR SHALL BE RESPONSIBLE FOR DETERMINING THE EXACT LOCATION OF THE AFOREMENTIONED ITEMS, SHOWN AND NOT SHOWN.

SITE NOTES

- PROJECT SITE AREA: 1.02 ACRES (44,466 SQUARE FEET)
- PROPOSED LOCATIONS OF TRAFFIC CONTROL MARKERS ARE APPROXIMATE. ACTUAL LOCATION AND INSTALLATION MUST MEET MUTCD AND BRYANT ROAD DEPT. SPECS.
- PAVEMENT SHALL BE CONSTRUCTED IN ACCORDANCE WITH AHTD SPECIFICATIONS, AND BASED ON GEOTECHNICAL ANALYSIS OF THE SOIL CONDITIONS.
- CONTRACTOR SHALL INCLUDE IN BID THE COST FOR COMPACTION TESTS ON SUBGRADE & BASE. TEST TO BE CONDUCTED AS PER GEOTECHNICAL ENGINEERS' SPECS.
- CONTRACTOR TO INCLUDE IN BID THE COST OF MATERIAL AND INSTALLATION OF STREET SIGNS & TRAFFIC CONTROL SIGNS.
- ALL UTILITIES TO BE LOCATED PRIOR TO CONSTRUCTION (ONE CALL, CITY, UTILITY OWNER, ETC.)
- CONTRACTOR TO ADHERE TO CURRENT OSHA EXCAVATION & TRENCH SAFETY REGULATIONS.
- THE APPROXIMATE LOCATION OF KNOWN SURFACE AND SUBSURFACE STRUCTURES, PIPES, POWER, GAS, PHONE, ETC. ARE SHOWN ON THE DESIGN DRAWINGS. THE CONTRACTOR SHALL BE RESPONSIBLE FOR DETERMINING THE EXACT LOCATION OF THE AFOREMENTIONED ITEMS, SHOWN AND NOT SHOWN.
- THIS PROJECT IS NOT IN THE 100 YEAR FLOOD HAZARD AREA. REFERENCE FIRM MAP 05125C0225E EFFECTIVE 06/05/2020
- CONTRACTOR IS RESPONSIBLE FOR COORDINATING TRAFFIC CONTROL WITH THE PROPER AUTHORITIES PRIOR TO CONSTRUCTION.

SITE PLAN NOTES:

- THERE ARE NO EROSION PROBLEMS ON THE SITE OR KNOWN EROSION PROBLEMS WITHIN 300' DOWNSTREAM.
- THERE IS NO SURFACE EVIDENCE OF EXISTING OR ABANDONED WATER WELLS, SUMPS, CESSPOOLS, SPRING WATER IMPOUNDMENTS, AND UNDERGROUND STRUCTURES WITHIN THE PROJECT.
- PAVEMENT SHALL BE CONSTRUCTED IN ACCORDANCE WITH AHTD SPECIFICATIONS, AND BASED ON GEOTECHNICAL ANALYSIS OF THE SOIL CONDITIONS.
- CONTRACTOR SHALL INCLUDE IN BID THE COST FOR COMPACTION TESTS ON SUBGRADE & BASE. TEST TO BE CONDUCTED AS PER GEOTECHNICAL SPECS.
- ALL UTILITIES TO BE LOCATED PRIOR TO CONSTRUCTION (ONE CALL, CITY, UTILITY OWNER, ETC.)
- CONTRACTOR TO ADHERE TO CURRENT OSHA REGULATIONS INCLUDING EXCAVATION & TRENCH SAFETY.
- THE APPROXIMATE LOCATION OF KNOWN SURFACE AND SUBSURFACE STRUCTURES, PIPES, POWER, GAS, PHONE, ETC. ARE SHOWN ON THE DESIGN DRAWINGS. THE CONTRACTOR SHALL BE RESPONSIBLE FOR AFOREMENTIONED ITEMS, SHOWN AND NOT SHOWN.

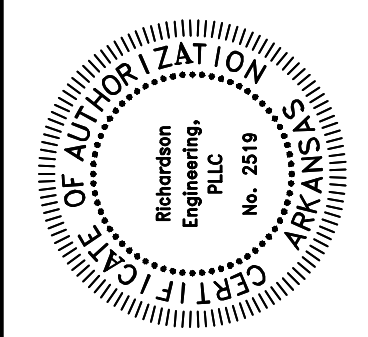
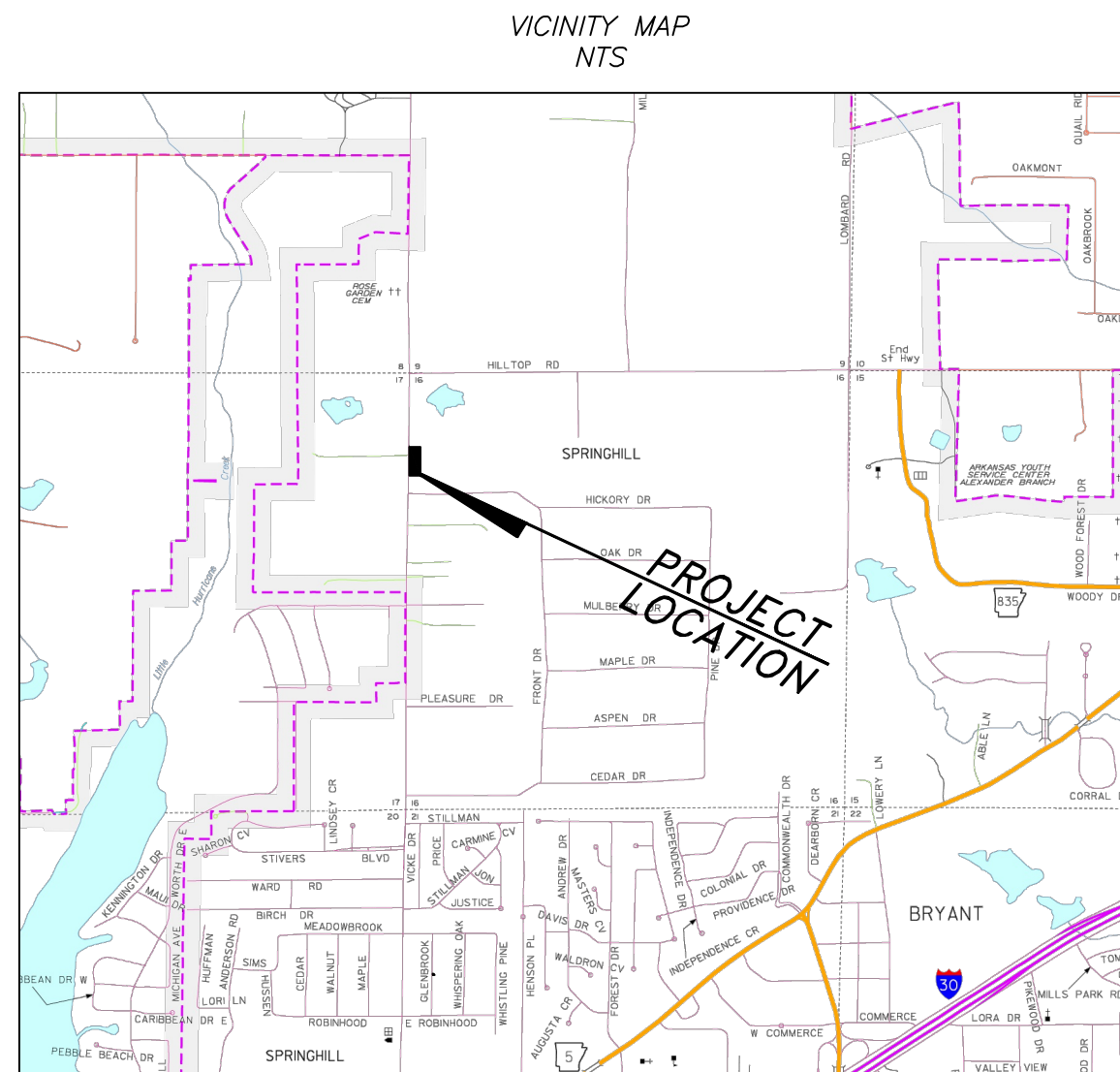

SITE PLAN  
CORNERSTONE MONTESSORI HALF STREET IMPROVEMENTS  
4910 SPRINGHILL RD  
BRYANT, ARKANSAS

Prepared For:  
STEPHEN NUCKOLS  
4910 SPRINGHILL RD  
BRYANT, AR

Date:

12/28/2025

Revisions:

FORCEMAIN REROUTE

No. 1

PROJECT #: 025-026

Date: 8-20-2025  
REV: 01/22/2026

Scale: 1" = 20'

Sheet: 4 of 7

PAVEMENT SECTION

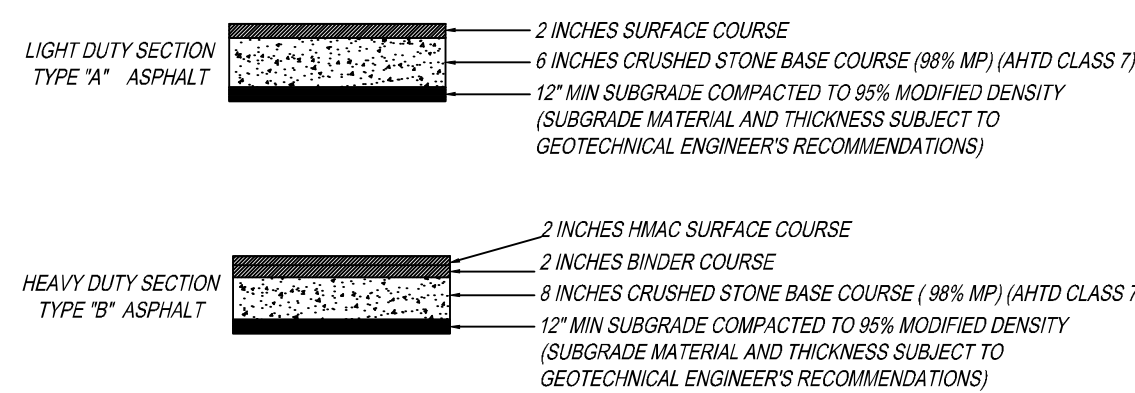

\* PAVEMENT SECTION SUBJECT TO GEOTECHNICAL ENGINEER'S RECOMMENDATIONS.

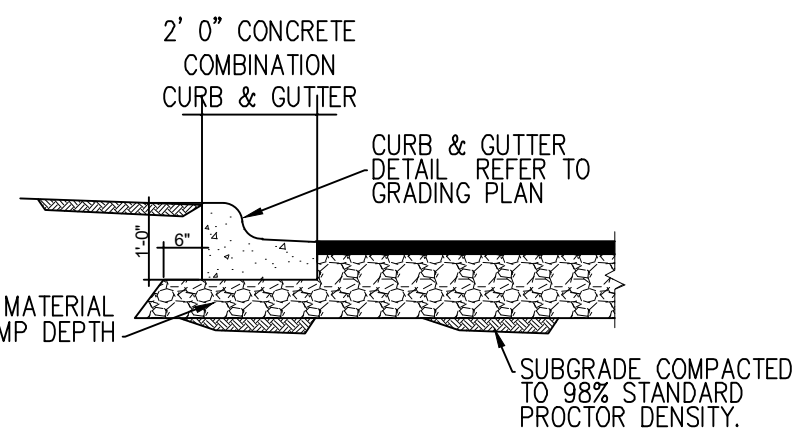

TYPICAL CURB & GUTTER DETAIL N.T.S.

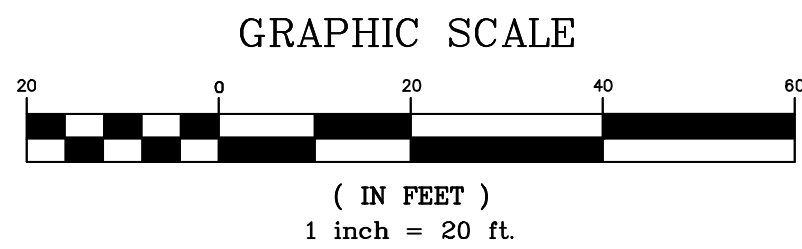

ENGINEER  
RICHARDSON ENGINEERING, PLLC  
ADDRESS: 325 W. SOUTH ST.  
BENTON, AR. 72015  
PHONE NO. (501) 315-7225  
PROJECT REPRESENTATIVE:  
TRISTIN PHILLIPS, P.E.

DEVELOPERS  
STEPHEN NUCKOLS  
4910 SPRINGHILL RD  
BRYANT, AR

CONCRETE PAVEMENT NOTES:

- CONCRETE TO BE 4000 PSI, SLUMP 4" +/- 1".
- INSTALL 1" DIA. X 18" L SMOOTH DOWELS ON 18" CENTERS AT CONTROL JOINTS.
- SAW CUT CONTROL JOINTS 15' MAX. EACH WAY AT A DEPTH OF 25% (1/4" PER 1") OF CONCRETE SECTION THICKNESS.
- AIR ENTRAINMENT 3-5%.
- FINISH TO BE MEDIUM BROOM FINISH.
- INSTALL EXPANSION JOINTS WHERE ABUTTING STRUCTURES AND AT A MAX. OF 200 LF OF PAVING. USE 3/4" EXPANSION JOINT MATERIAL WHERE EXPANSION JOINTS ARE SPECIFIED. USE 1" DIA. X 18" L SMOOTH DOWELS ON 18" CENTERS IN EXPANSION JOINTS BETWEEN PAVEMENT SECTIONS.

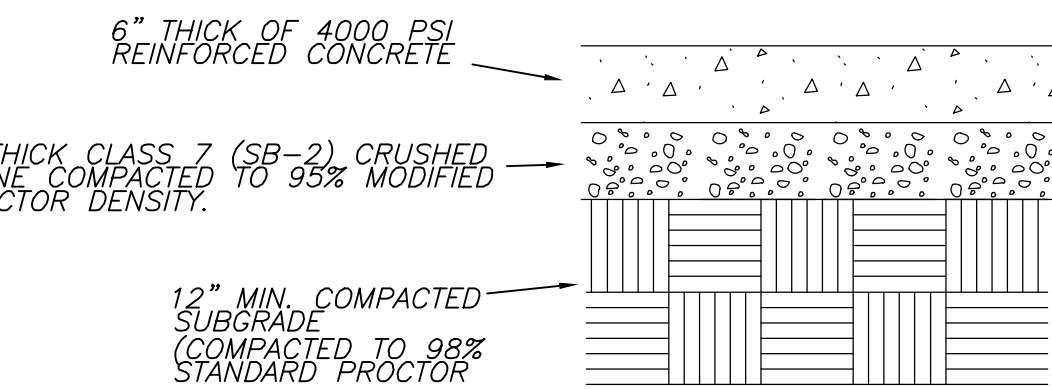

\* CONCRETE PAVEMENT AND REINFORCEMENT TO BE VERIFIED PER ACI 330R-08-SP8 AND SUBJECT TO GEOTECHNICAL ENGINEER'S RECOMMENDATIONS.

HEAVY DUTY  
CONCRETE PAVEMENT SECTION (OPTIONAL)  
NTS

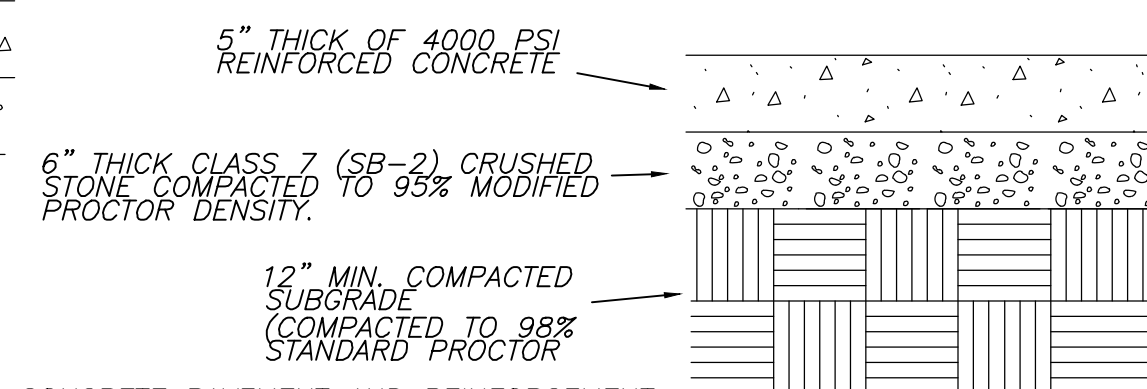

\* CONCRETE PAVEMENT AND REINFORCEMENT TO BE VERIFIED PER ACI 330R-08-SP8 AND SUBJECT TO GEOTECHNICAL ENGINEER'S RECOMMENDATIONS.

LIGHT DUTY  
CONCRETE PAVEMENT SECTION (OPTIONAL)  
NTS

Legend

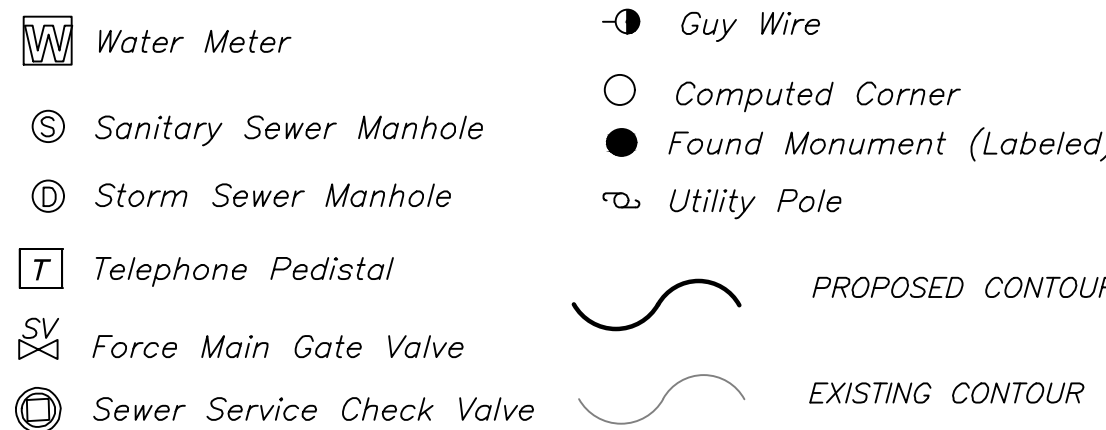
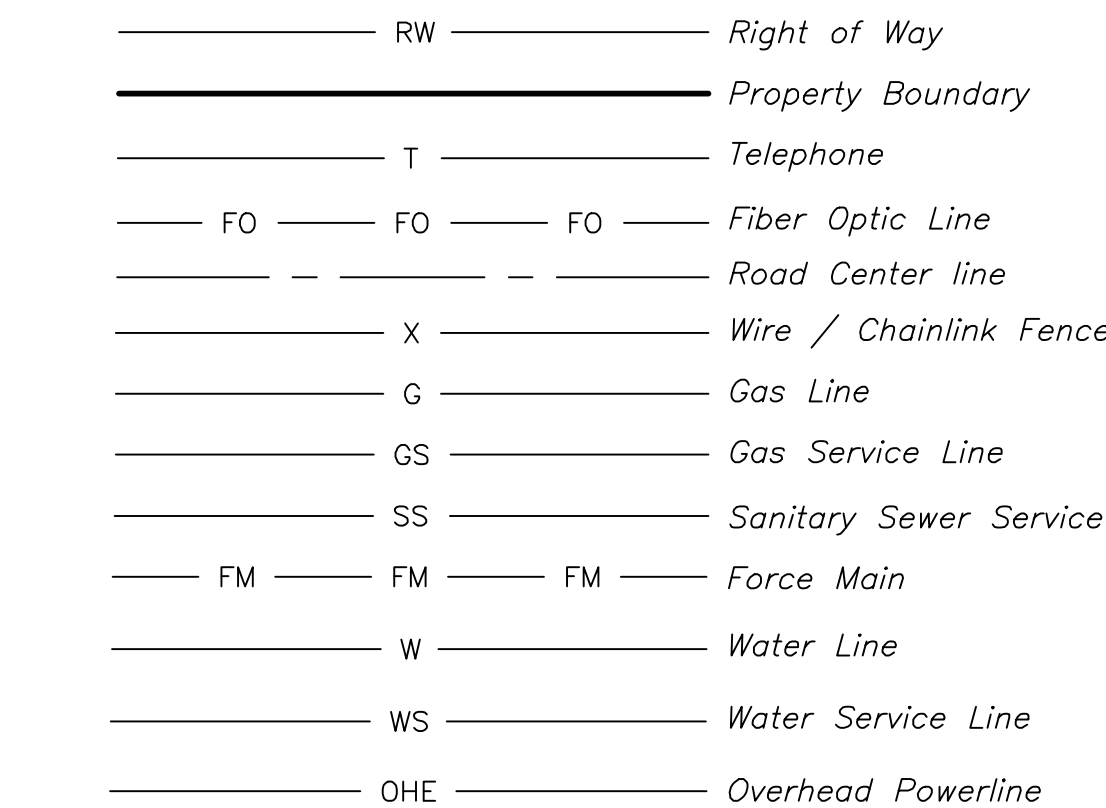



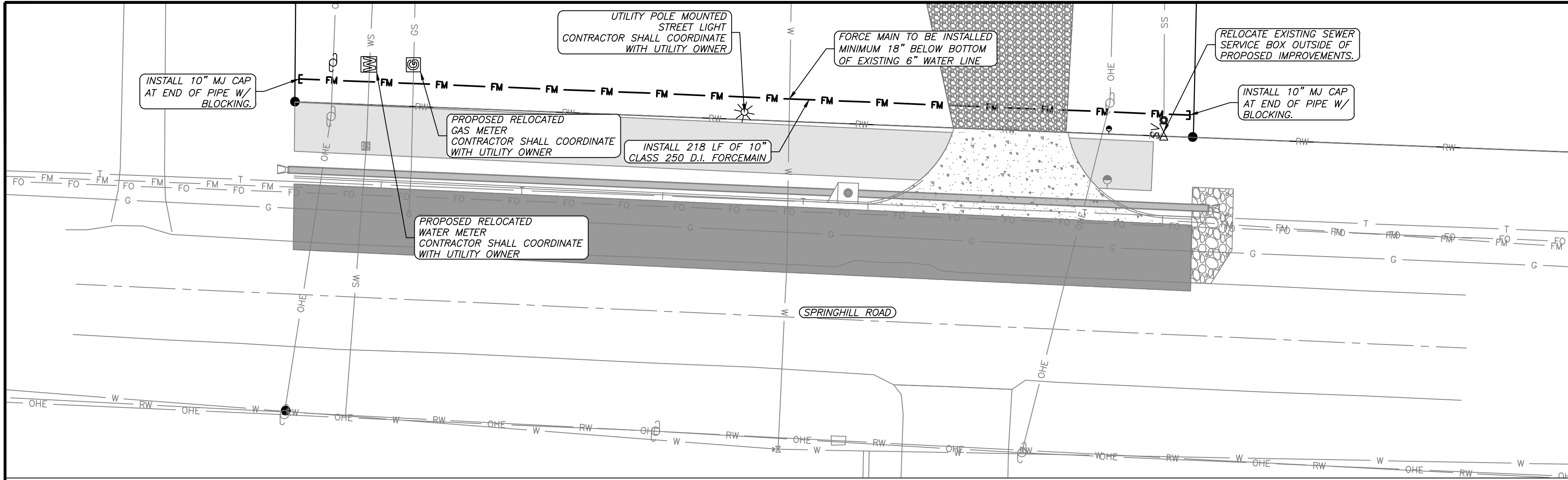

#### GENERAL NOTES:

- 1.) PAVEMENT SHALL BE CONSTRUCTED IN ACCORDANCE WITH THIS PLAN AND BASED ON GEOTECHNICAL ANALYSIS OF THE SOIL CONDITIONS.
- 2.) ATTENTION IS CALLED TO CONSTRUCTION DETAILS FOR ADDITIONAL INFORMATION.
- 3.) CONSTRUCTION SITE SHALL ADHERE TO BRYANT STORMWATER REQUIREMENTS, AND SHALL MEET ALL APPLICABLE ADEO STANDARDS FOR EROSION CONTROL MEASURES.
- 4.) ALL UTILITIES TO BE LOCATED PRIOR TO CONSTRUCTION (ONE CALL, CITY, ETC.)
- 5.) CONTRACTOR TO ADHERE TO CURRENT OSHA REGULATIONS INCLUDING EXCAVATION & TRENCH SAFETY.
- 6.) THE APPROXIMATE LOCATION OF KNOWN SURFACE AND SUBSURFACE STRUCTURES, PIPES, POWER, GAS, PHONE, ETC. ARE SHOWN ON THE DESIGN DRAWINGS. THE CONTRACTOR SHALL BE RESPONSIBLE FOR DETERMINING THE EXACT LOCATION OF THE AFOREMENTIONED ITEMS, SHOWN AND NOT SHOWN.

#### SITE NOTES

- 1.) PROJECT SITE AREA: 1.02 ACRES (44,466 SQUARE FEET)
- 2.) PROPOSED LOCATIONS OF TRAFFIC CONTROL MARKERS ARE APPROXIMATE. ACTUAL LOCATION AND INSTALLATION MUST MEET MUTCD AND BRYANT ROAD DEPT. SPECS.
- 3.) PAVEMENT SHALL BE CONSTRUCTED IN ACCORDANCE WITH AHTD SPECIFICATIONS, AND BASED ON GEOTECHNICAL ANALYSIS OF THE SOIL CONDITIONS.
- 4.) CONTRACTOR SHALL INCLUDE IN BID THE COST FOR COMPACTION TESTS ON SUBGRADE & BASE. TEST TO BE CONDUCTED AS PER GEOTECHNICAL ENGINEERS' SPECS.
- 5.) CONTRACTOR TO INCLUDE IN BID THE COST OF MATERIAL AND INSTALLATION OF STREET SIGNS & TRAFFIC CONTROL SIGNS.
- 6.) ALL UTILITIES TO BE LOCATED PRIOR TO CONSTRUCTION (ONE CALL, CITY, UTILITY OWNER, ETC.)
- 7.) CONTRACTOR TO ADHERE TO CURRENT OSHA EXCAVATION & TRENCH SAFETY REGULATIONS.
- 8.) THE APPROXIMATE LOCATION OF KNOWN SURFACE AND SUBSURFACE STRUCTURES, PIPES, POWER, GAS, PHONE, ETC. ARE SHOWN ON THE DESIGN DRAWINGS. THE CONTRACTOR SHALL BE RESPONSIBLE FOR DETERMINING THE EXACT LOCATION OF THE AFOREMENTIONED ITEMS, SHOWN AND NOT SHOWN.
- 9.) THIS PROJECT IS NOT IN THE 100 YEAR FLOOD HAZARD AREA. REFERENCE FIRM MAP 05125C0225E EFFECTIVE 06/05/2020
- 10.) CONTRACTOR IS RESPONSIBLE FOR COORDINATING TRAFFIC CONTROL WITH THE PROPER AUTHORITIES PRIOR TO CONSTRUCTION.

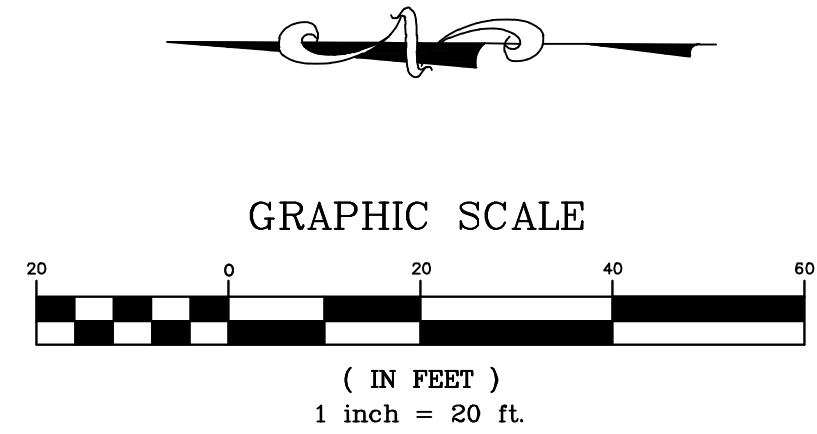

ENGINEER  
RICHARDSON ENGINEERING, PLLC  
ADDRESS: 325 W.SOUTH ST.  
BENTON, AR. 72015  
PHONE NO. (501) 315-7225  
PROJECT REPRESENTATIVE:  
TRISTIN PHILLIPS, P.E.

DEVELOPERS  
STEPHEN NUCKOLS  
4910 SPRINGHILL RD  
BRYANT, AR

**RICHARDSON ENGINEERING**  
Planning • Engineering • Development Consulting

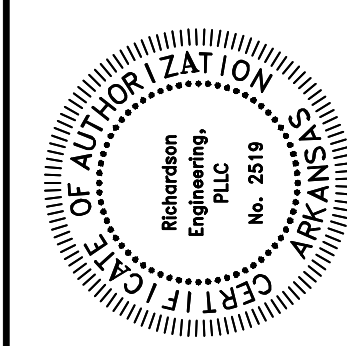

SITE PLAN  
CORNERSTONE MONTESSORI HALF  
STREET IMPROVEMENTS  
4910 SPRINGHILL RD  
BRYANT, ARKANSAS

Prepared For:  
STEPHEN NUCKOLS  
4910 SPRINGHILL RD  
BRYANT, AR

No.	Revisions	Date
1	FORCEMAIN REROUTE	12/28/2023

PROJECT #: 025-026  
Scale: 8-20-2025  
REV: 01/22/2026  
Date: 1" = 20'  
Sheet: 5 of 7

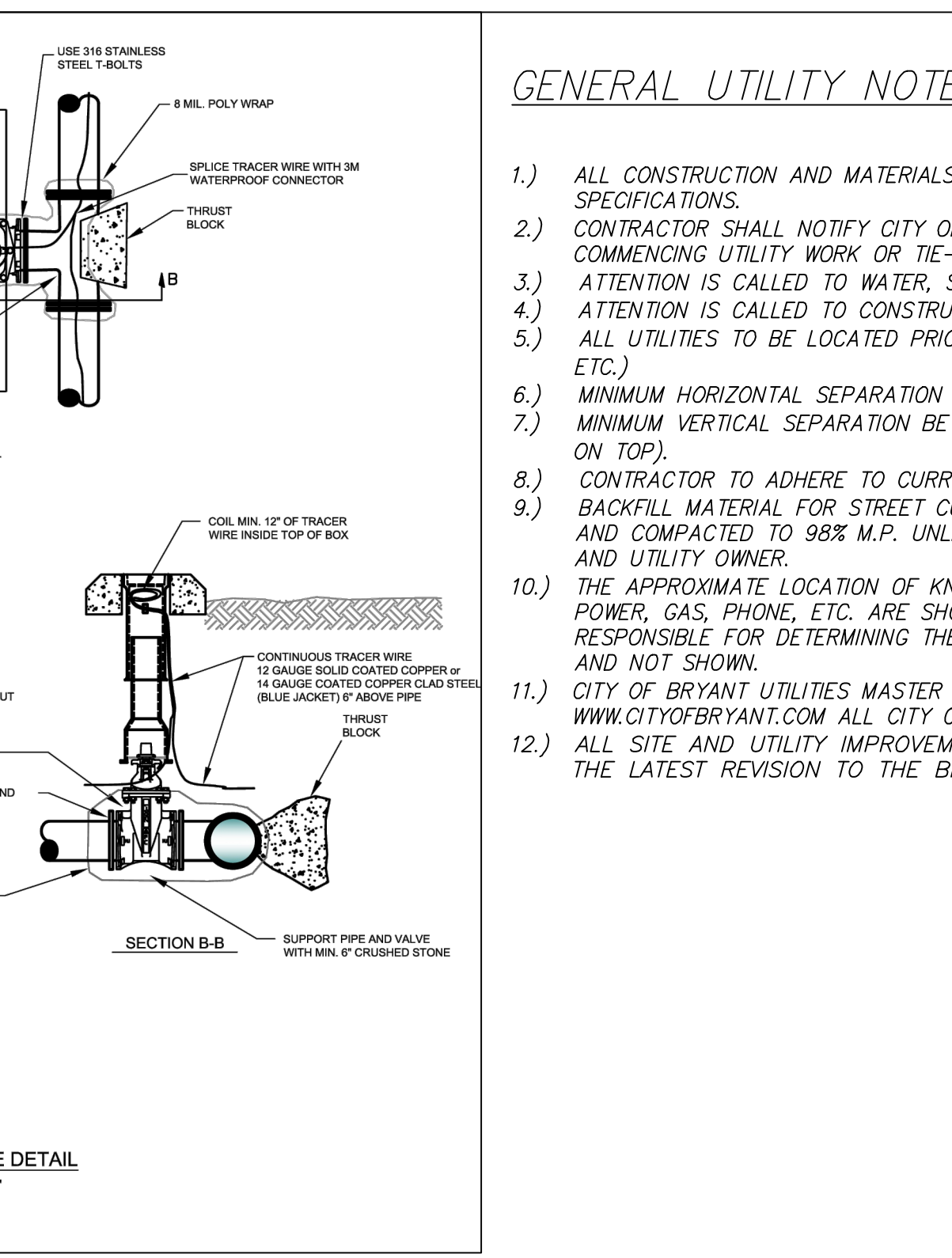
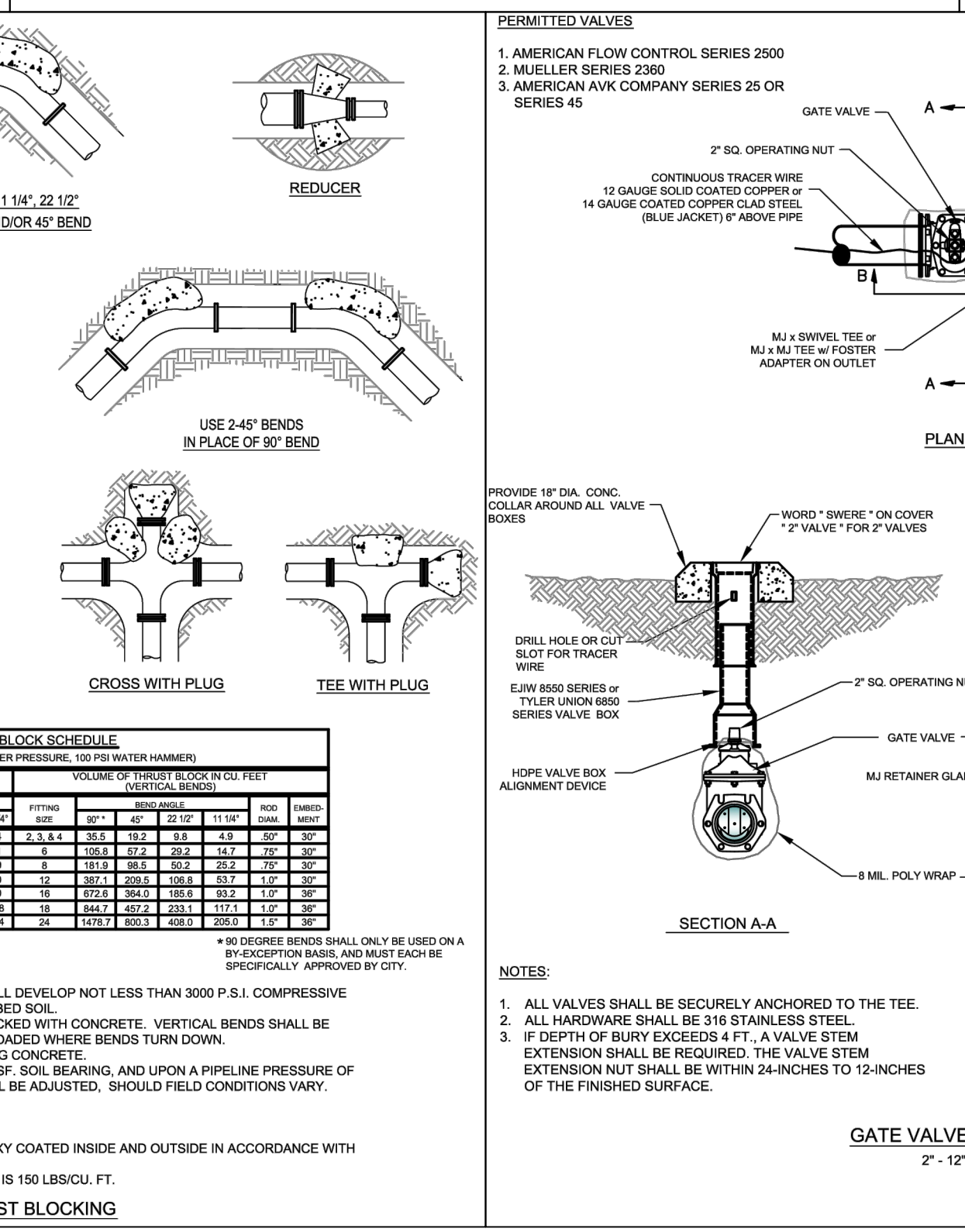
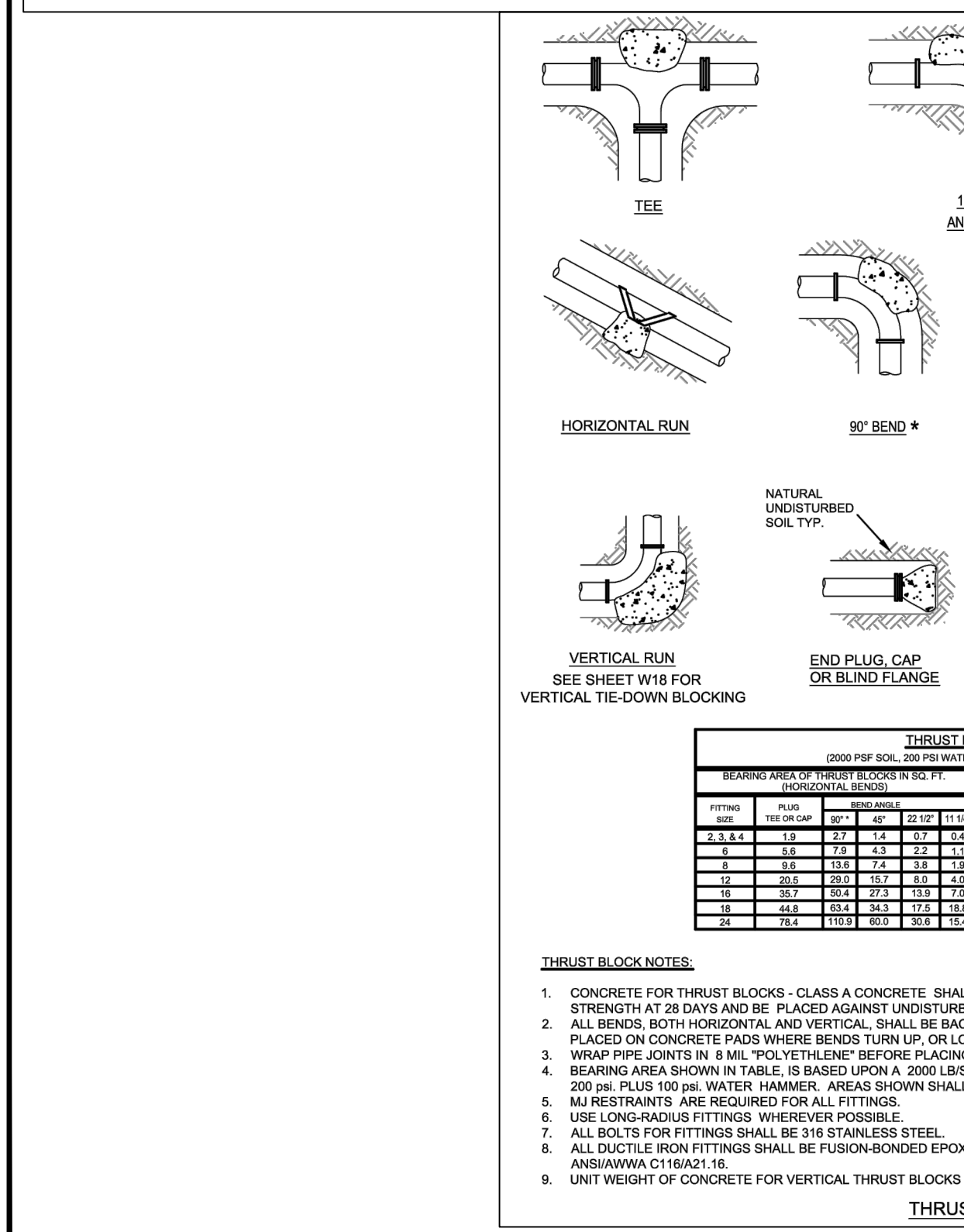
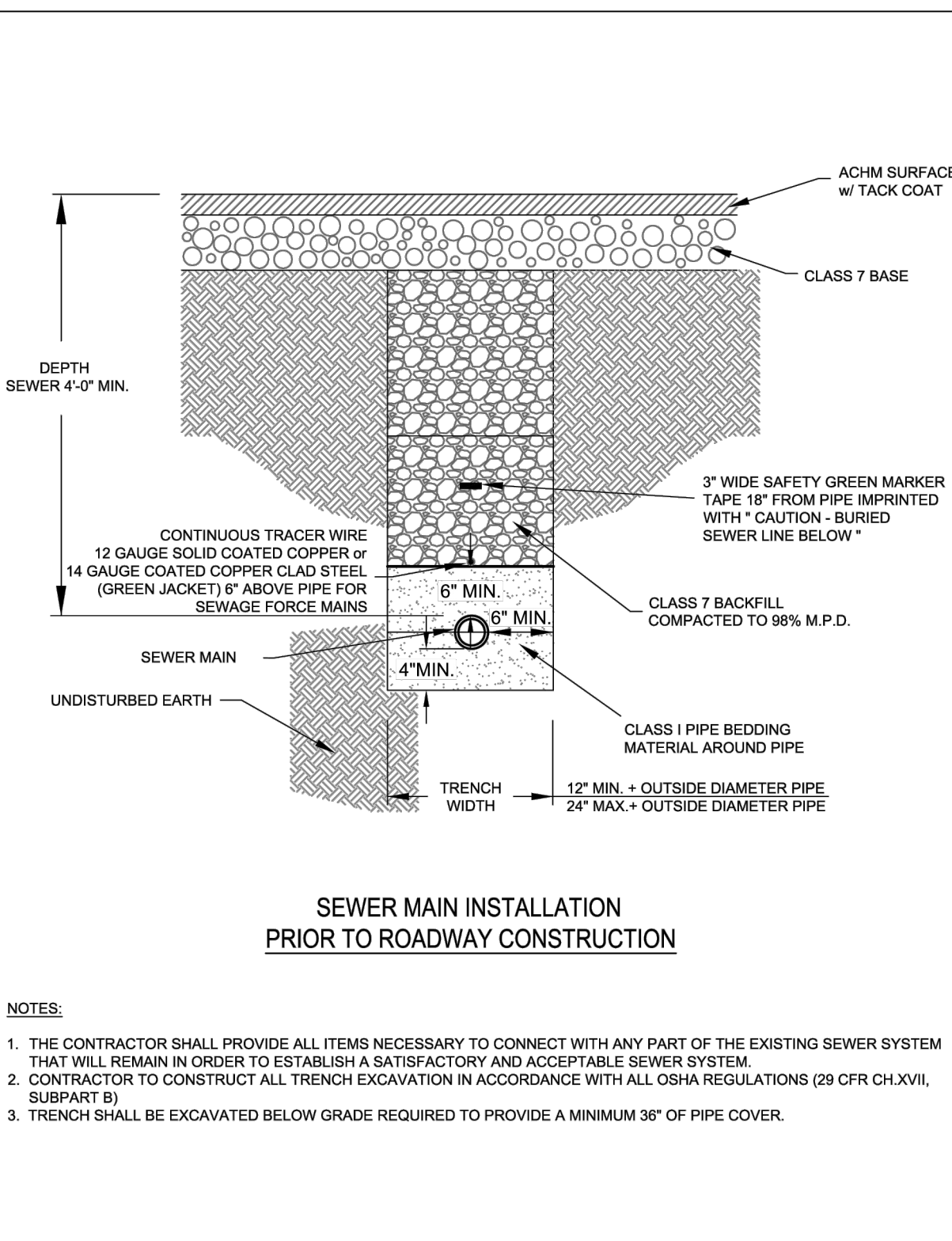
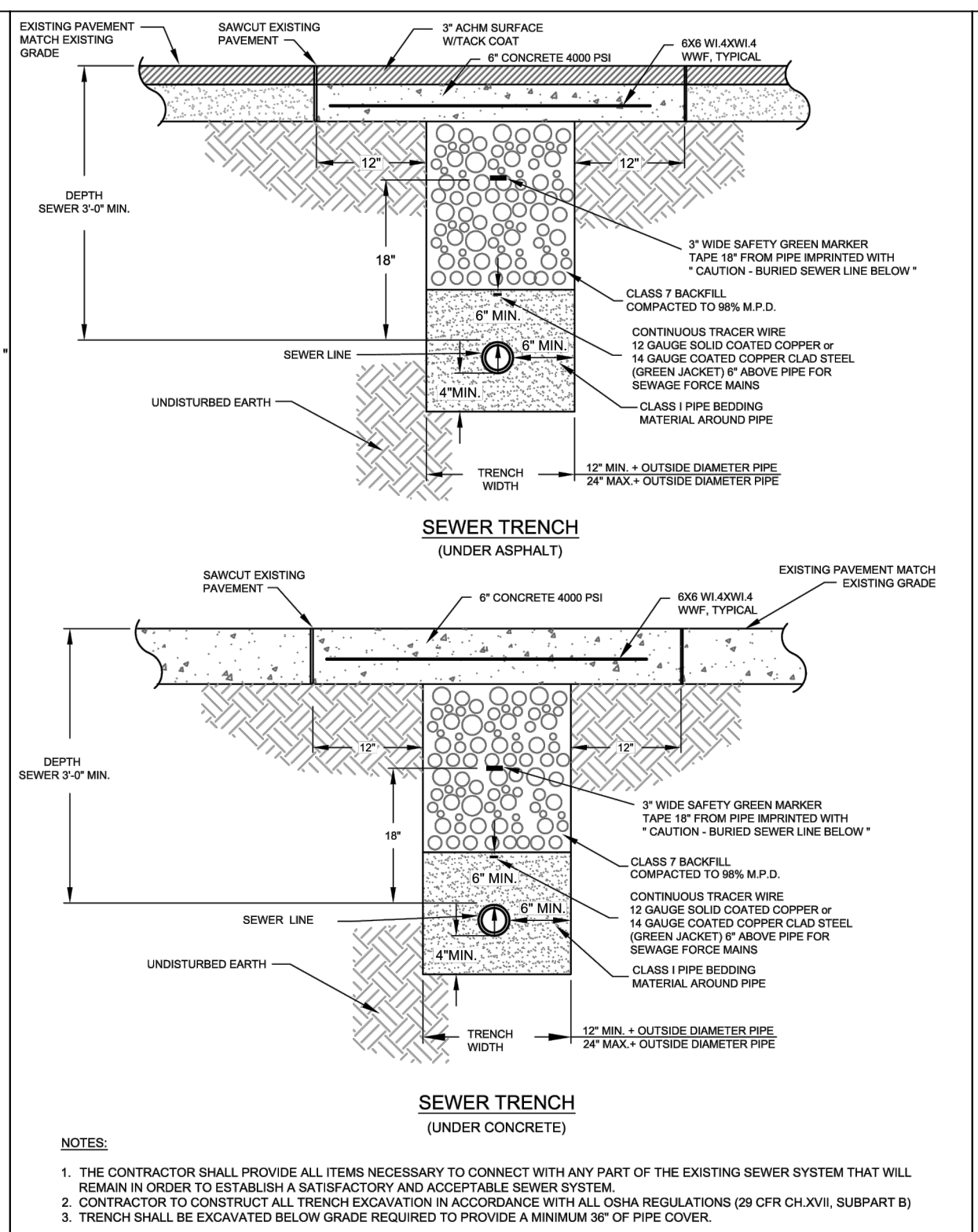
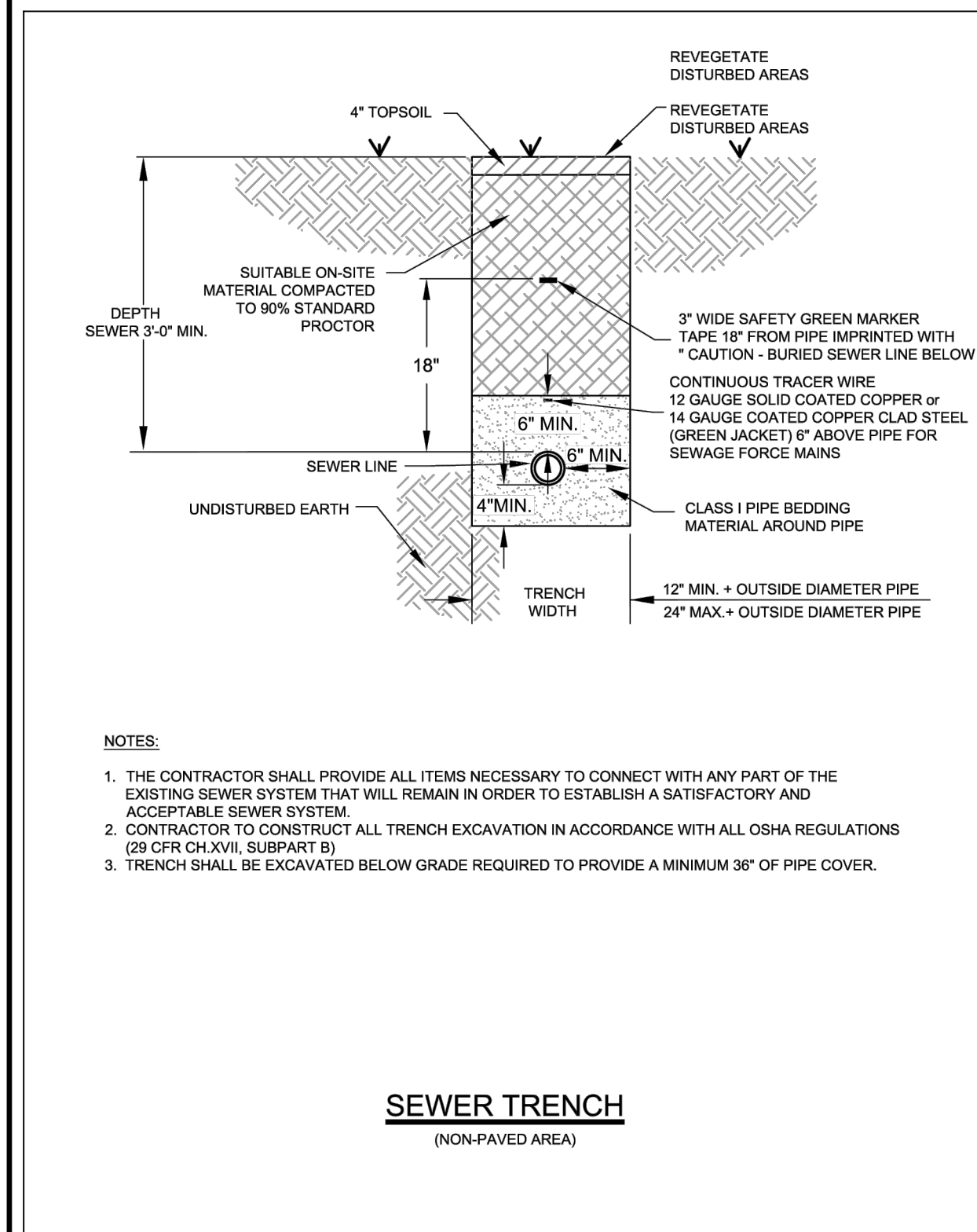

#### GENERAL UTILITY NOTES:

- 1.) ALL CONSTRUCTION AND MATERIALS TO MEET OR EXCEED CITY OF BRYANT UTILITIES' SPECIFICATIONS.
- 2.) CONTRACTOR SHALL NOTIFY CITY OF BRYANT UTILITIES AT LEAST 48 HOURS PRIOR TO COMMENCING UTILITY WORK OR TIE-INS.
- 3.) ATTENTION IS CALLED TO WATER, SEWER, AND STREET LAYOUT FOR ADDITIONAL INFORMATION.
- 4.) ATTENTION IS CALLED TO CONSTRUCTION DETAILS FOR ADDITIONAL INFORMATION.
- 5.) ALL UTILITIES TO BE LOCATED PRIOR TO CONSTRUCTION (ONE CALL, CITY, UTILITY OWNER, ETC.)
- 6.) MINIMUM HORIZONTAL SEPARATION BETWEEN WATERLINES AND SEWERLINES SHALL BE 10'.
- 7.) MINIMUM VERTICAL SEPARATION BETWEEN WATERLINES AND SEWERLINES SHALL BE 18" (WATER ON TOP).
- 8.) CONTRACTOR TO ADHERE TO CURRENT OSHA EXCAVATION & TRENCH SAFETY REGULATIONS.
- 9.) BACKFILL MATERIAL FOR STREET CUTS SHALL BE ACCORDING TO BRYANT STREET DEPT SPECS AND COMPACTED TO 98% M.P. UNLESS OTHERWISE APPROVED IN WRITING BY THE ENGINEER AND UTILITY OWNER.
- 10.) THE APPROXIMATE LOCATION OF KNOWN SURFACE AND SUBSURFACE STRUCTURES, PIPES, POWER, GAS, PHONE, ETC. ARE SHOWN ON THE DESIGN DRAWINGS. THE CONTRACTOR SHALL BE RESPONSIBLE FOR DETERMINING THE EXACT LOCATION OF THE AFOREMENTIONED ITEMS, SHOWN AND NOT SHOWN.
- 11.) CITY OF BRYANT UTILITIES MASTER SPECIFICATIONS APPLY AND ARE AVAILABLE AT WWW.CITYOFBRYANT.COM ALL CITY OF BRYANT UTILITIES SPECIFICATIONS APPLY.
- 12.) ALL SITE AND UTILITY IMPROVEMENTS SHALL BE CONSTRUCTED IN ACCORDANCE WITH THE LATEST REVISION TO THE BRYANT UTILITIES STANDARD SPECIFICATIONS.

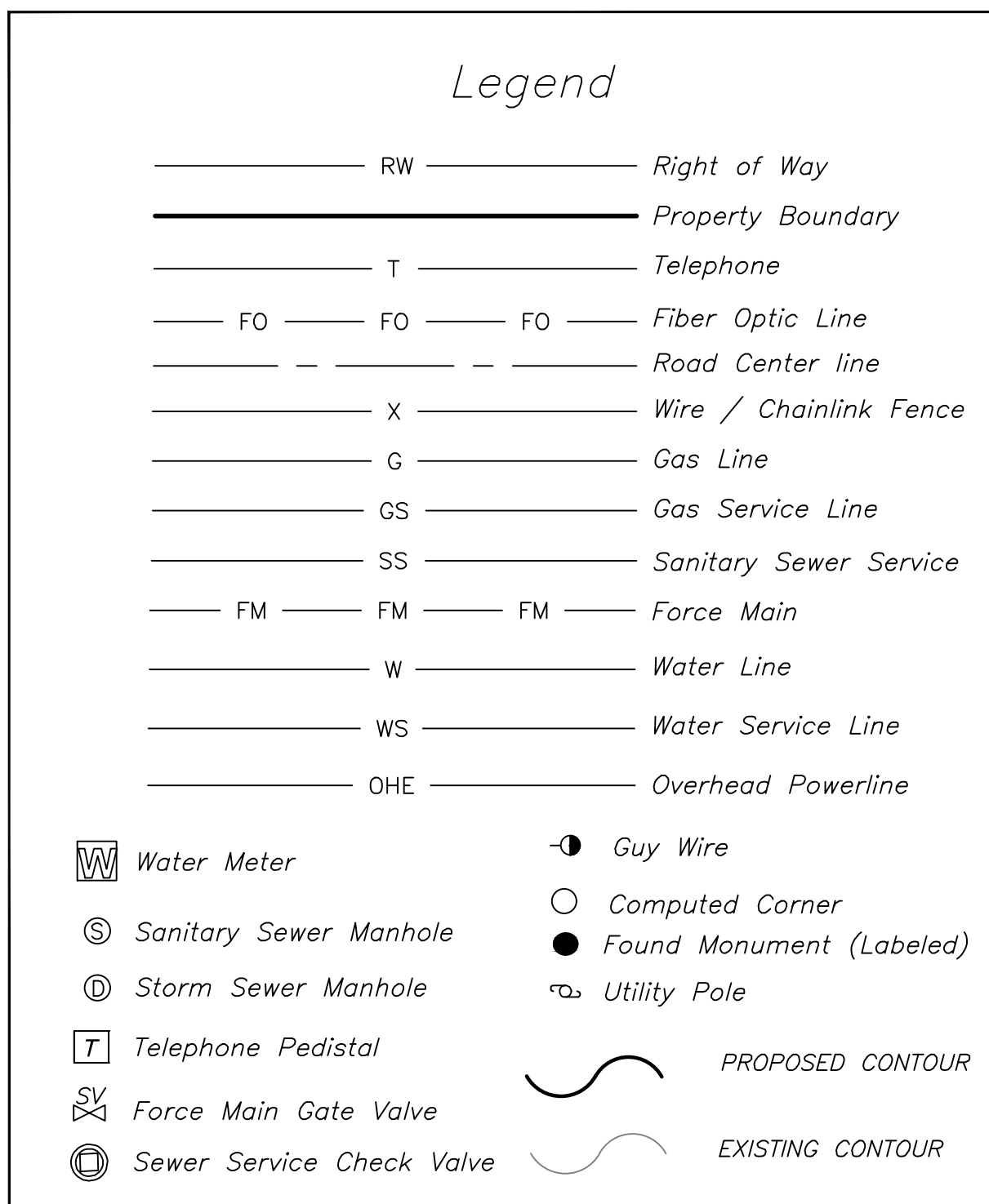



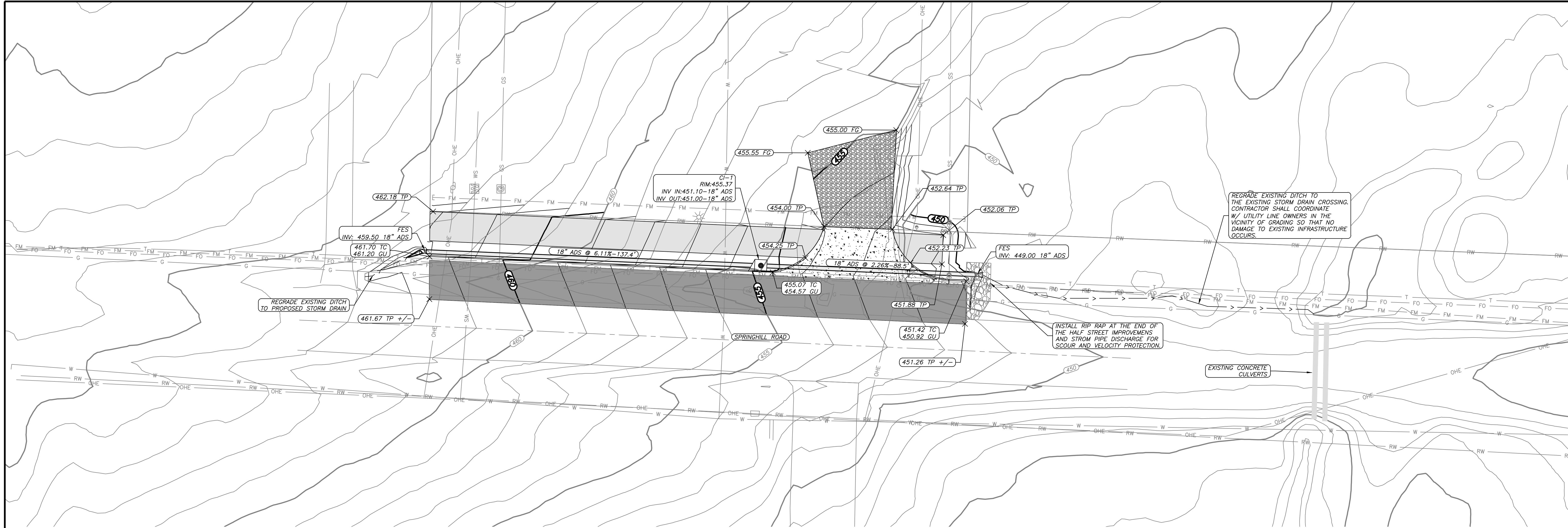

VICINITY MAP  
NTS

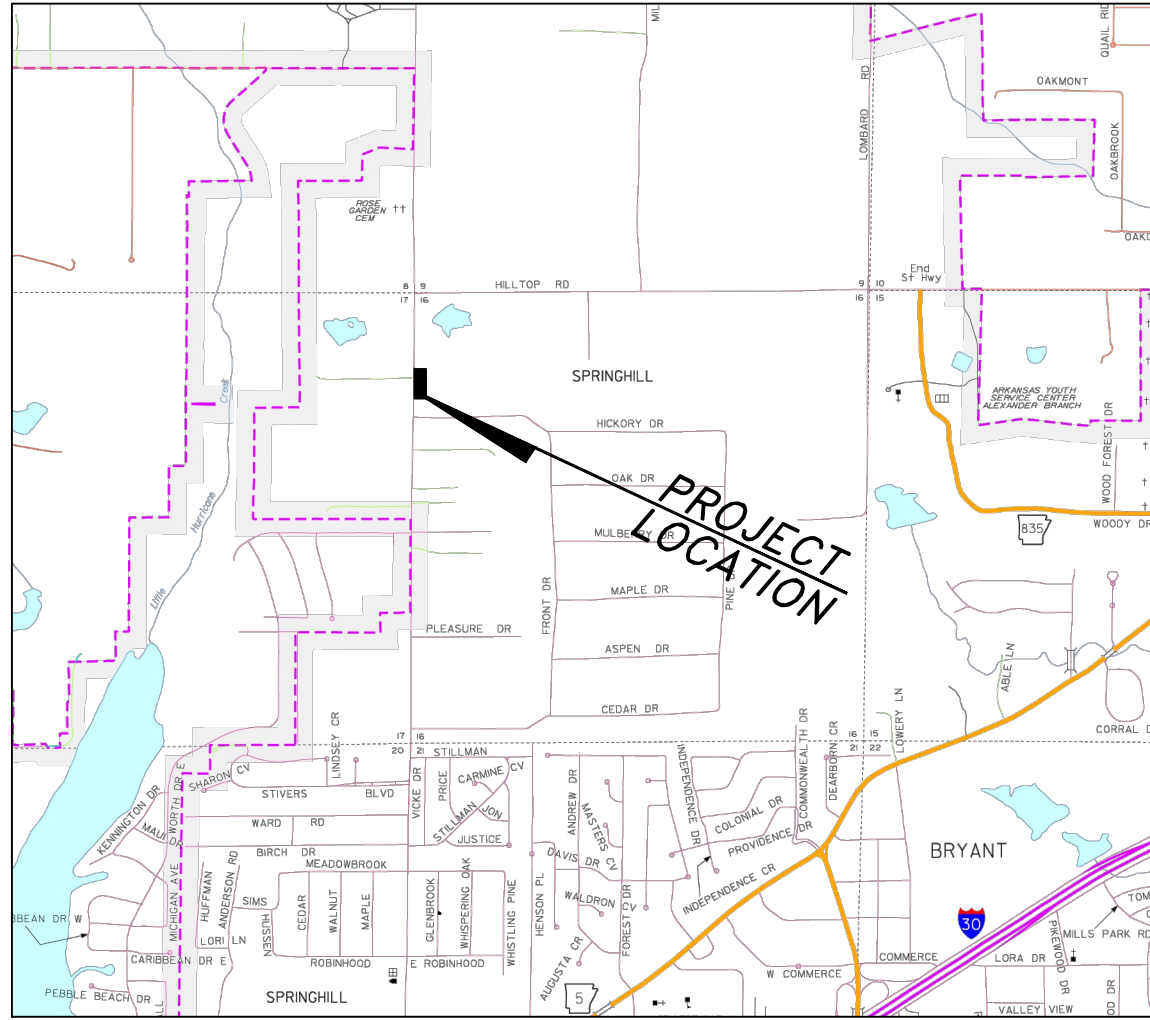

PROPOSED STORM PROFILE

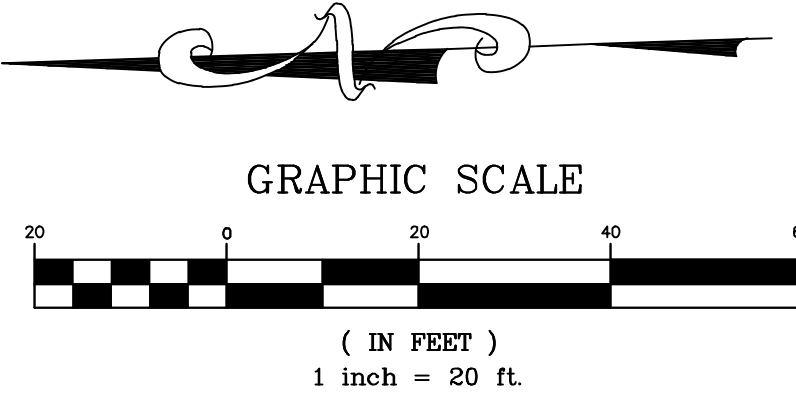
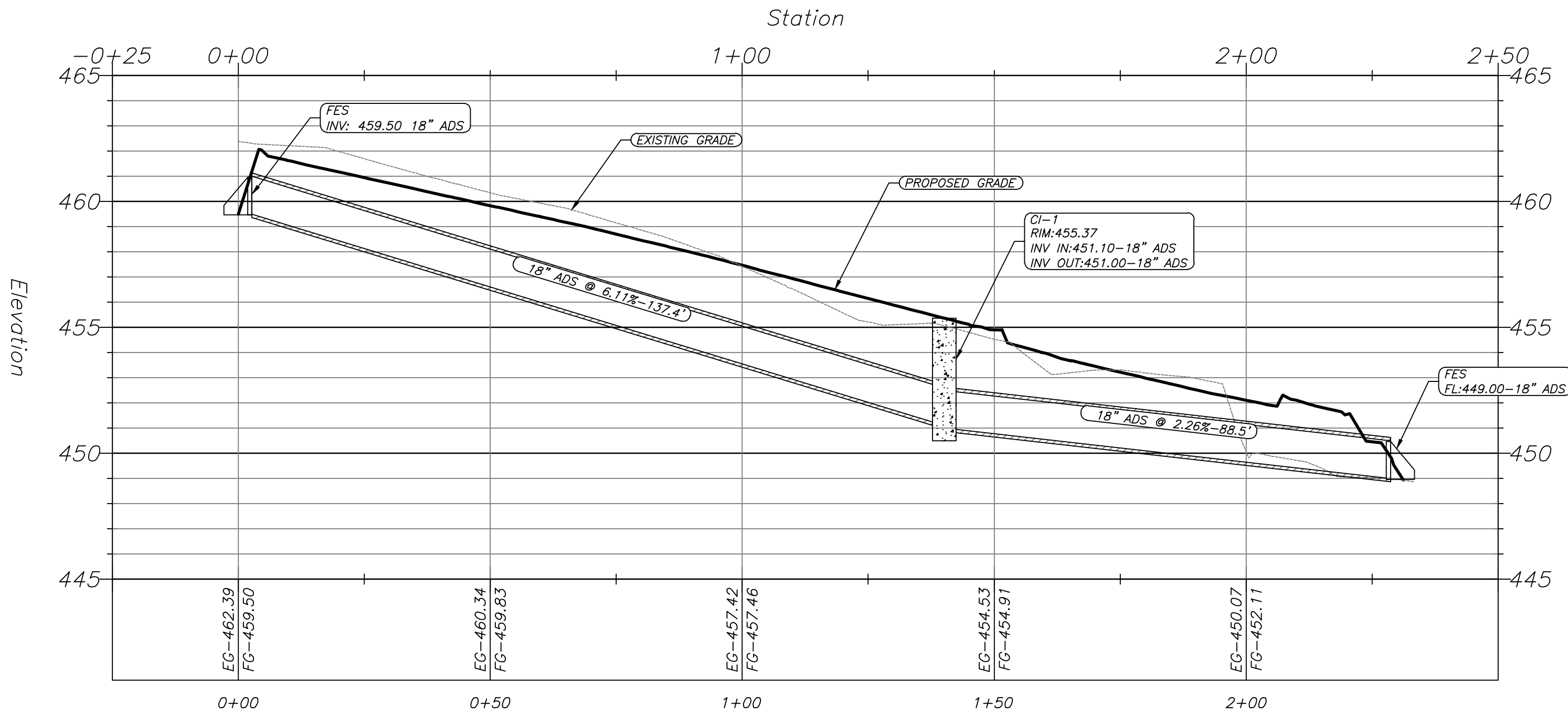

Legend

- RW Right of Way
- Property Boundary
- T Telephone
- FO Fiber Optic Line
- Road Center line
- X Wire / Chainlink Fence
- G Gas Line
- GS Gas Service Line
- SS Sanitary Sewer Service
- FM Force Main
- W Water Line
- WS Water Service Line
- OHE Overhead Powerline

- Water Meter
- Sanitary Sewer Manhole
- Storm Sewer Manhole
- Telephone Pedestal
- Force Main Gate Valve
- Sewer Service Check Valve
- Guy Wire
- Computed Corner
- Found Monument (Labeled)
- Utility Pole
- PROPOSED CONTOUR
- EXISTING CONTOUR

- GENERAL NOTES:
- PAVEMENT SHALL BE CONSTRUCTED IN ACCORDANCE WITH THIS PLAN AND BASED ON GEOTECHNICAL ANALYSIS OF THE SOIL CONDITIONS.
  - ATTENTION IS CALLED TO CONSTRUCTION DETAILS FOR ADDITIONAL INFORMATION.
  - CONSTRUCTION SITE SHALL ADHERE TO CITY OF BRYANT STORMWATER REQUIREMENTS, AND SHALL MEET ALL APPLICABLE ADEQ STANDARDS FOR EROSION CONTROL MEASURES.
  - ALL UTILITIES TO BE LOCATED PRIOR TO CONSTRUCTION (ONE CALL, CITY, ETC.)
  - CONTRACTOR TO ADHERE TO CURRENT OSHA REGULATIONS INCLUDING EXCAVATION & TRENCH SAFETY.
  - THE APPROXIMATE LOCATION OF KNOWN SURFACE AND SUBSURFACE STRUCTURES, PIPES, POWER GAS, PHONE, ETC. ARE SHOWN ON THE DESIGN DRAWINGS. THE CONTRACTOR SHALL BE RESPONSIBLE FOR DETERMINING THE EXACT LOCATION OF THE AFOREMENTIONED ITEMS, SHOWN AND NOT SHOWN.
  - CONTRACTOR IS RESPONSIBLE FOR COORDINATING TRAFFIC CONTROL WITH THE PROPER AUTHORITIES.

**RICHARDSON**  
**ENGINEERING**  
Planning • Engineering • Development Consulting  
325 W. SOUTH STREET, BENTON, AR 72015 (501)315-7225

GRADING PLAN  
CORNERSTONE MONTESSORI HALF  
STREET IMPROVEMENTS  
4910 SPRINGHILL RD  
BRYANT, ARKANSAS

Prepared For:  
**STEPHEN NUCKOLS**  
**4910 SPRINGHILL RD**  
**BRYANT, AR**

Date:	Revision:
12/09/2023	
	FORCEMAIN REROUTE

PROJECT #: 025-026  
Scale: 1" = 20'  
Date: 8-20-2025  
REV: 01/22/2026  
Sheet: 6 of 7



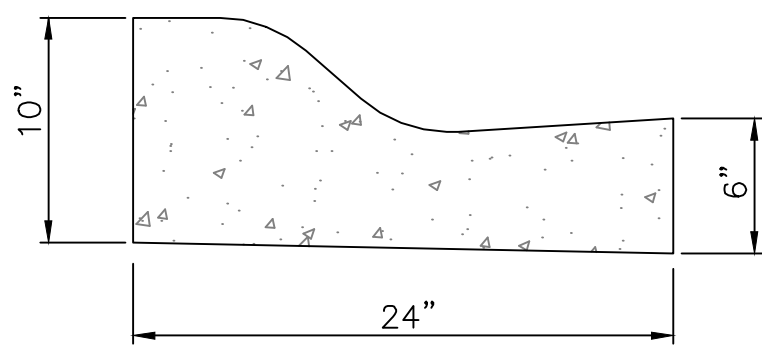

TYPICAL - 4" CONC.  
CURB/GUTTER  
NTS

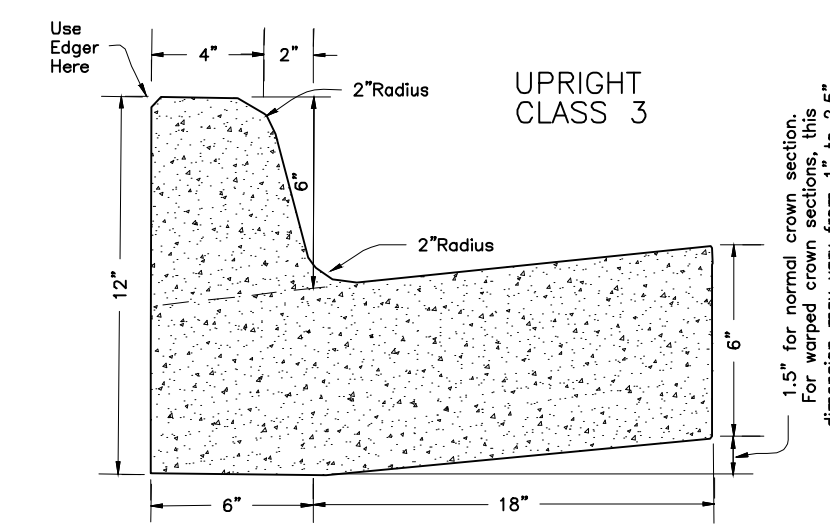

TYPICAL 6" PARKING CURB SECTION  
NTS

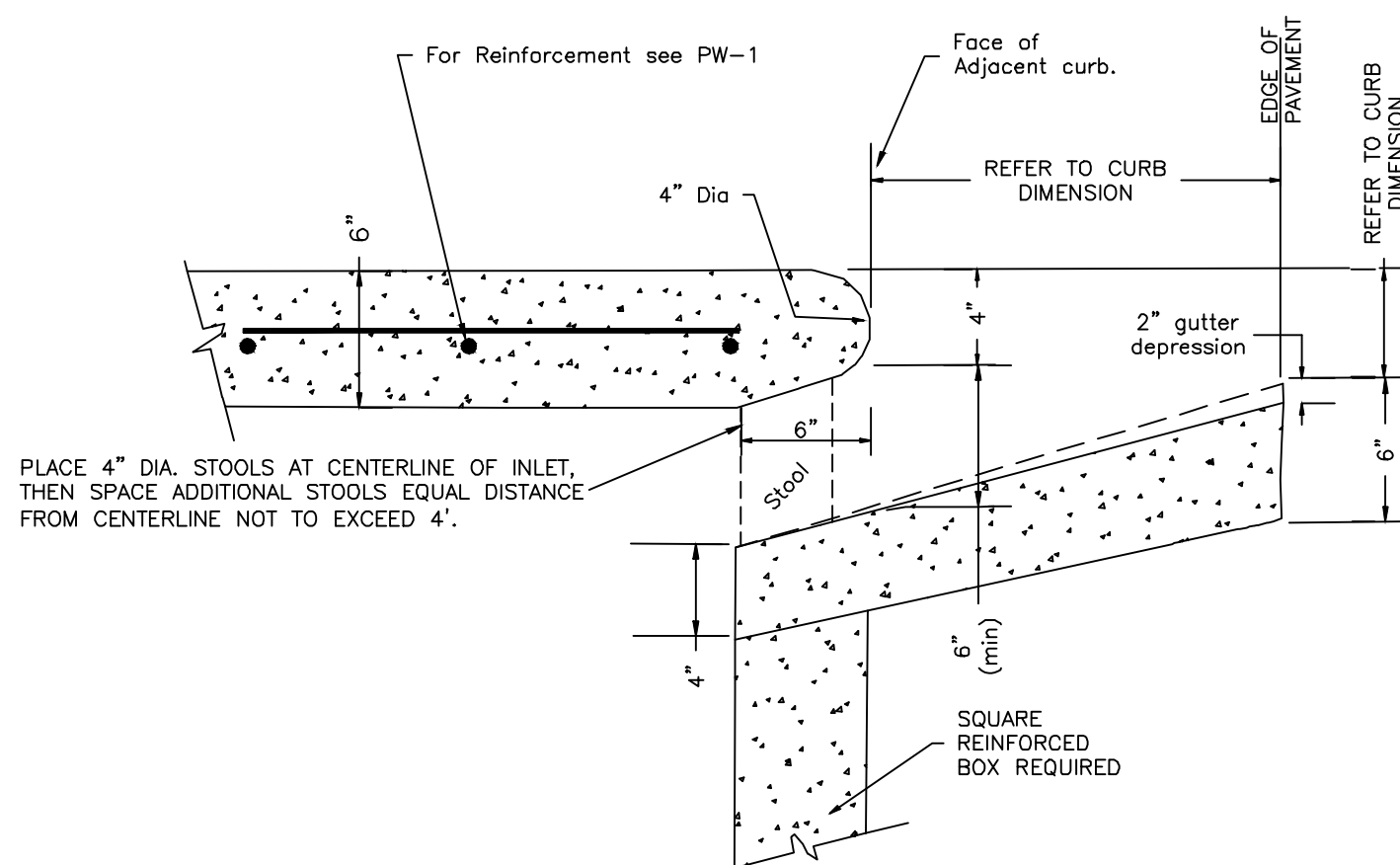

NOTE: This detail is not to be used for inlets in curb radius.  
See PW-10 for detail of inlet top in curb radius.

INLET THROAT BETWEEN STOOLS

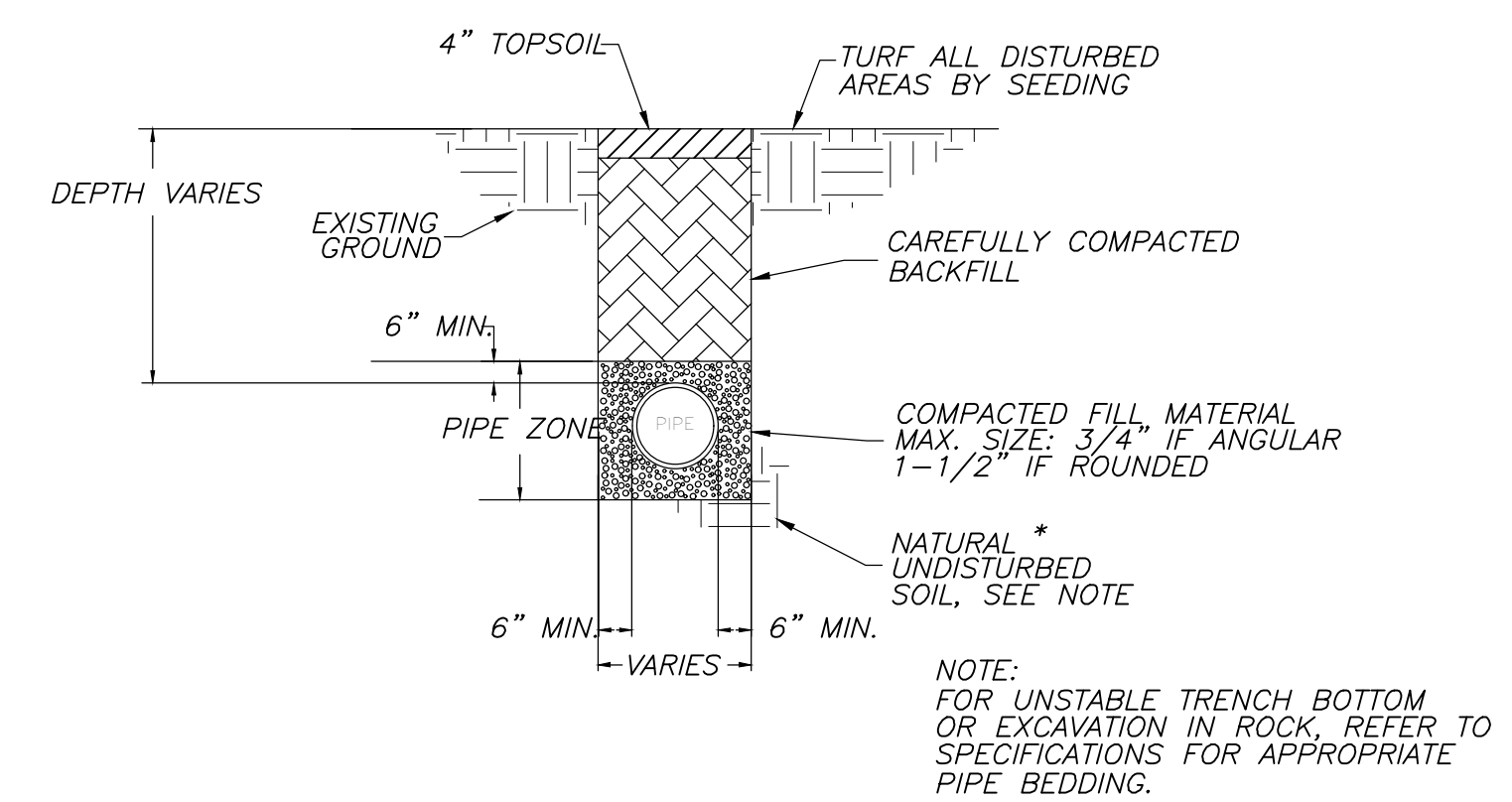

STORM DRAINAGE PIPE TRENCH (UNPAVED AREA)  
NTS

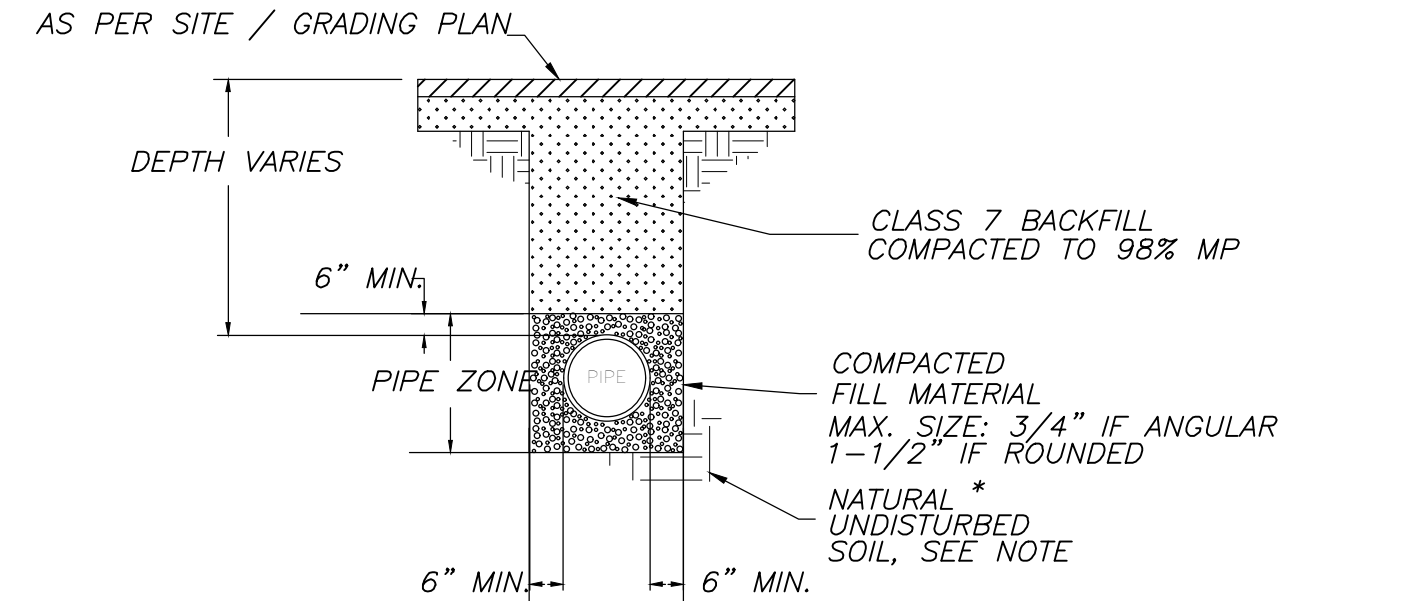

STORM DRAINAGE PIPE TRENCH (UNDER ASPHALT)  
NTS

REFER TO CITY OF BENTON, ARKANSAS PUBLIC WORKS  
STREET AND DRAINAGE STANDARD DETAILS FOR ADDITIONAL  
DETAILS AND INFORMATION.

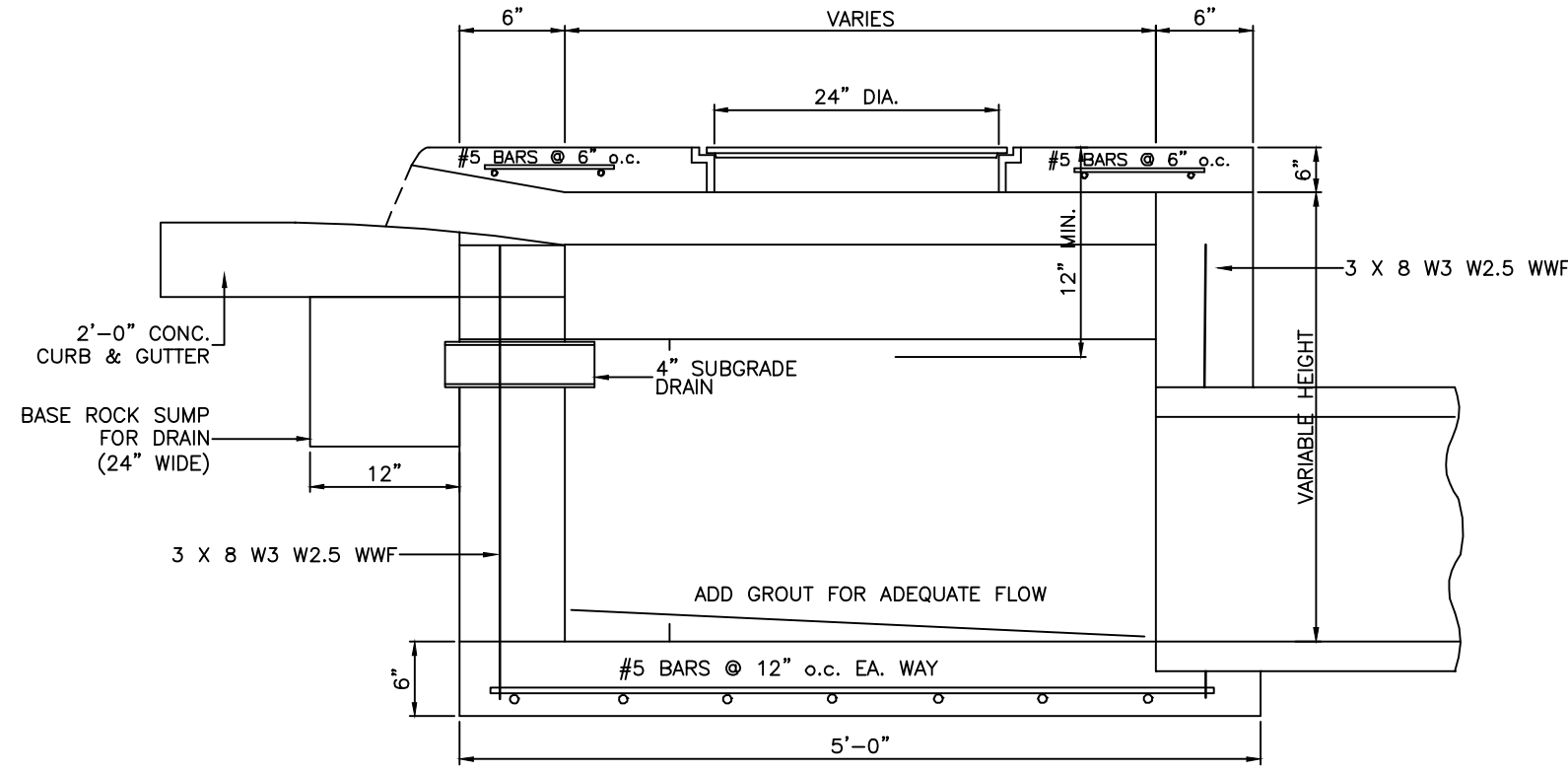

TYPICAL DROP INLET - POURED IN PLACE  
ELEVATION

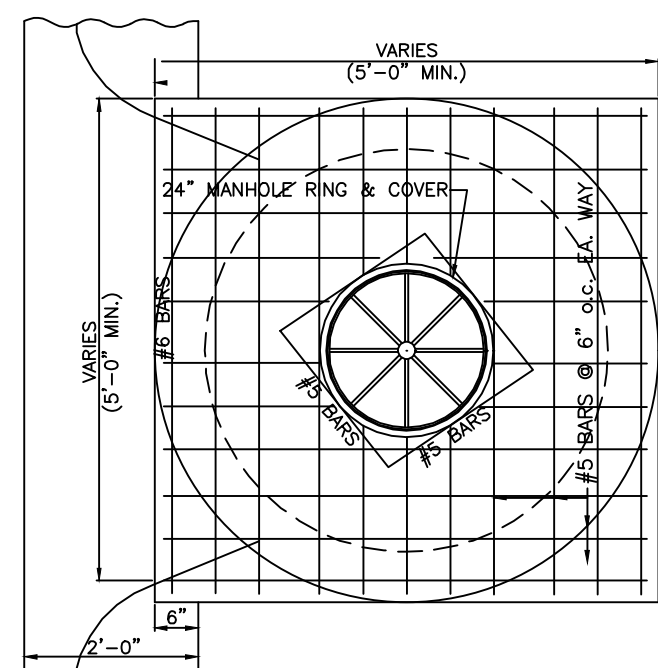

TYPICAL DROP INLET  
PLAN

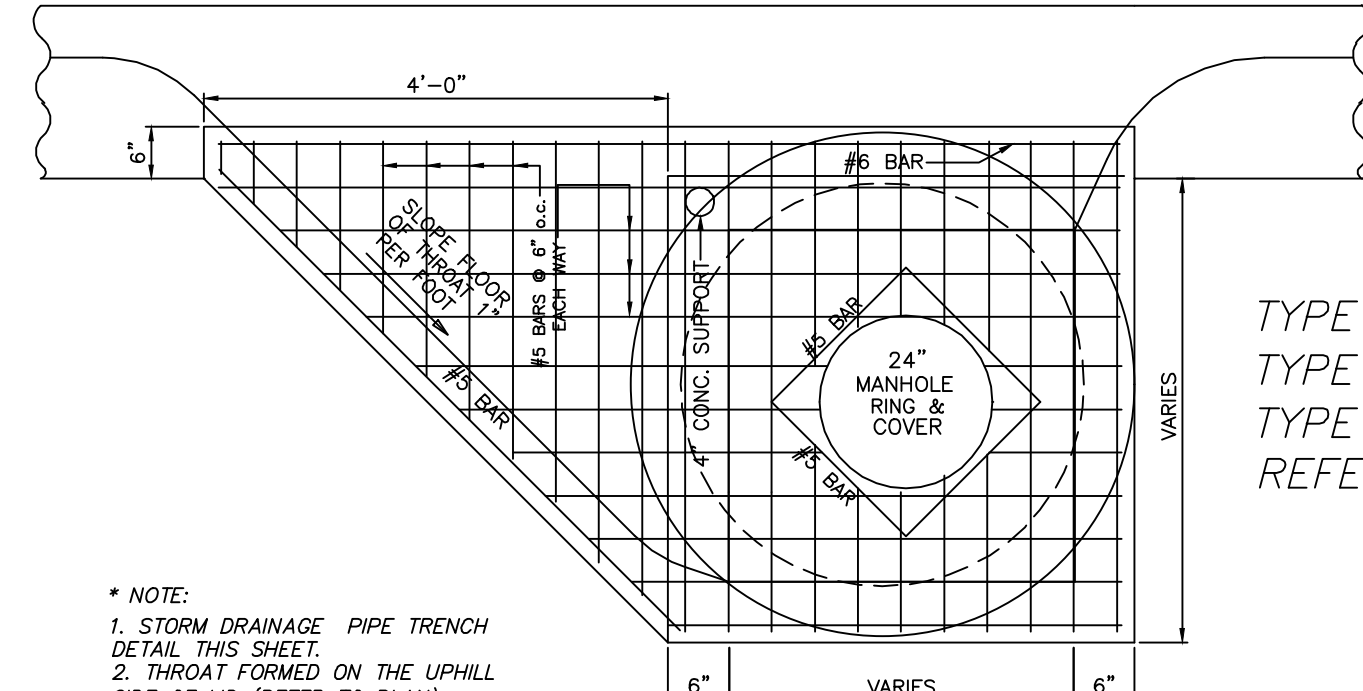

\* NOTE:  
1. STORM DRAINAGE PIPE TRENCH  
DETAIL THIS SHEET.  
2. THROAT FORMED ON THE UPHILL  
SIDE OF LID (REFER TO PLAN).  
3. ID= INSIDE DIAMETER  
OD= OUTSIDE DIAMETER

DETAIL - STORM DRAIN MAHOLE  
TYPE 1 THROAT

TYPE A = 4' ID/ 5' OD  
TYPE B = 5' ID/ 6' OD  
TYPE C = 6' ID/ 7' OD  
REFER TO PLAN FOR BOX TYPE

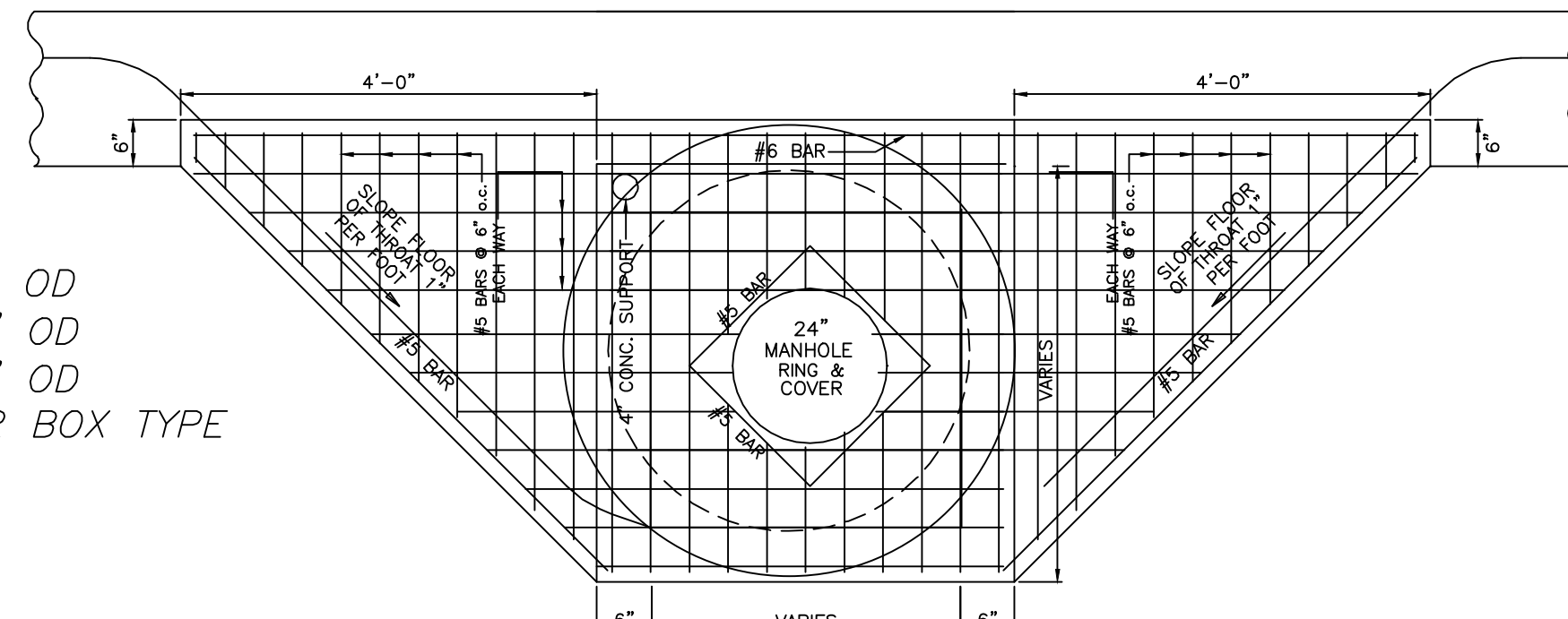

DETAIL - STORM DRAIN MANHOLE  
TYPE 2 THROAT

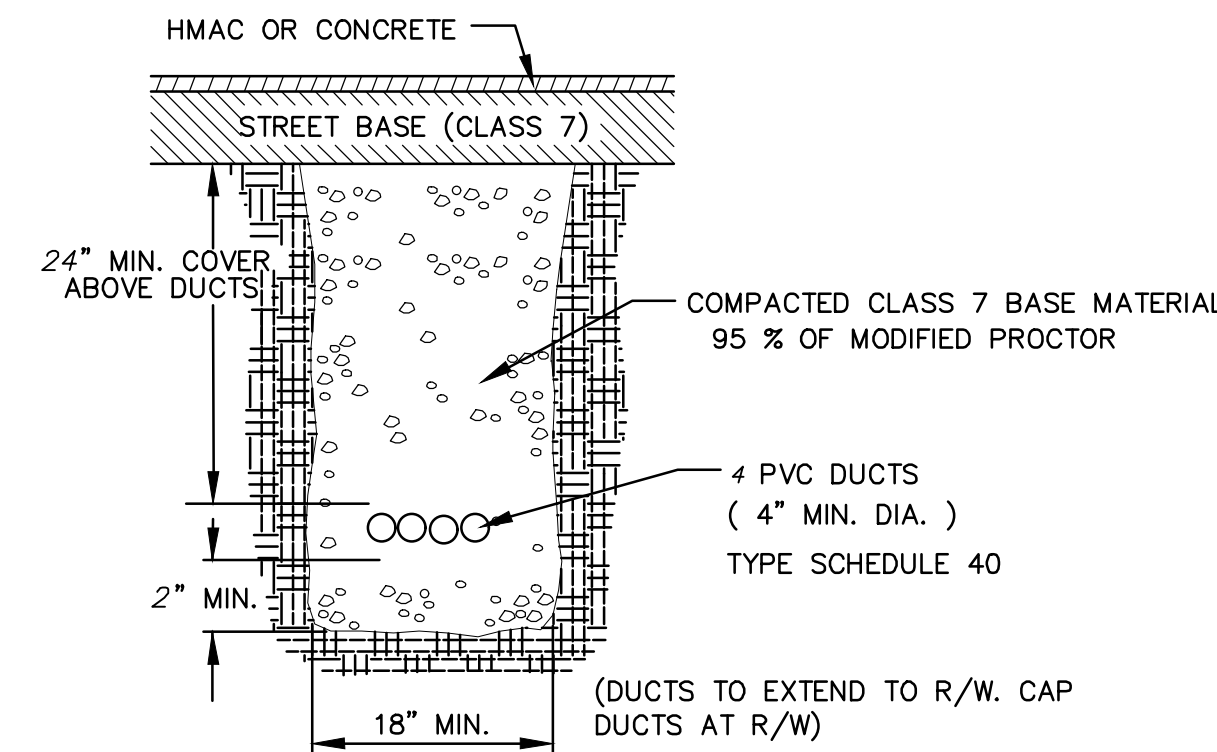

TYPICAL SECTION  
4-4" UTILITY DUCTS

NOT TO SCALE