

GNE

Designing our client's success

P.O. Box 116

3825 Mt Carmel Rd

Benton, AR 72018

Bryant, AR 72022

Ph (501) 408-4650

garnatengineering@gmail.com

FOR EXCLUSIVE USE & BENEFIT OF:

Name: BART FERGUSON

LEGEND

- △ - Computed point
- - Found monument
- ⊙ - Set #4 RB/Plas. Cap
- (M) - Measured
- (R) - Record
- (P) - Platted

NOTES:

1. WILL UTILIZE DUMPSTER AT REAR OF PARCEL PER APPROVED SCHEMATIC PLAN. DUMPSTER ENCLOSURE WILL COMPLY W/ CITY OF BRYANT STANDARDS.

FND 5/8" RBR

Landscape Requirements

1 Tree Required

1 Tree Provided

8 Evergreen Shrubs Required

8 Evergreen Shrubs Provided

100 Sq. Ft. Bedding/Groundcover Required

122 Sq. Ft. Groundcover Provided

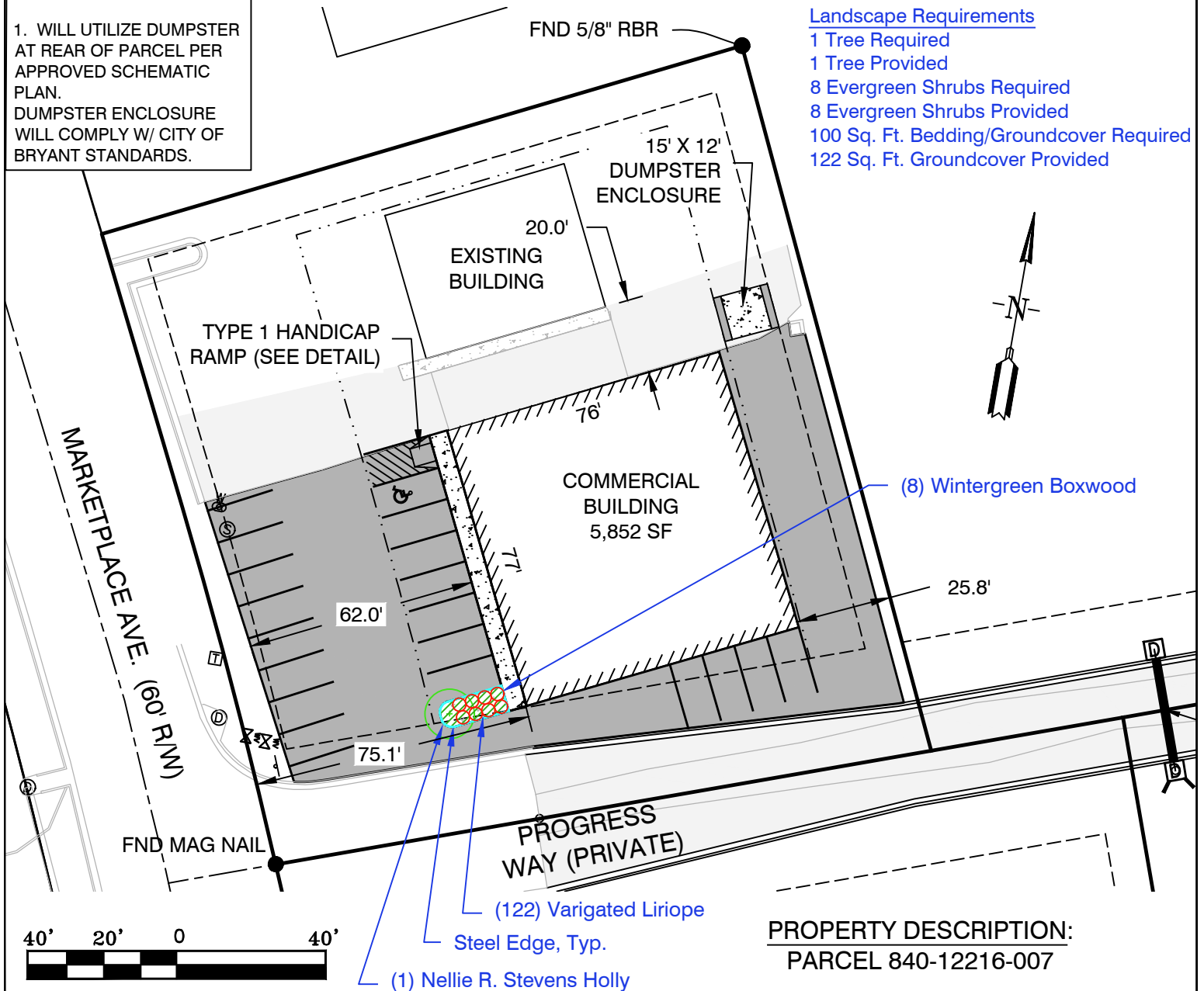

PROPERTY DESCRIPTION:

PARCEL 840-12216-007

JOB NUMBER:

**20022
MARKETPLACE
EAST, PHASE 1**

10/30/2025

PLOT PLAN

This Plot Plan depicts the lot as it appears on the subdivision final plat. This drawing does not represent an actual survey.

According to the the Federal Emergency Management Agency (FEMA) Flood Insurance Rate Map (FIRM) for Saline County unincorporated areas, panel # 05125C0240E dated 06/05/2020, no portion, dated of the property described hereon does lie within the 100 year flood hazard boundary.