

- NOTES**
1. **Basis of Bearings:** Grid North, Arkansas State Plans Coordinate System, South Zone (0302), NAD 83, Based on GPS Observations on NGS Primary Airport Control Station SUZ A and NGS OPUS processed Solution at Latitude- 34°55'14.61307"N, Longitude- 92°29'10.44585"W, having a convergence Angle of -0.2724118 degrees and a Combined Scale Factor of 0.999945015. The Vertical values are in reference to the NAVD of 1988. See Key Map This Sheet For Control Point Location.
 2. See Sheet 5 For Typical Paving Sections.
 3. The 6" Yellow Centerline Marking Shall Include A 6" Black Border On Each Side When Marking On Exist. Asphalt Pavements. The Black Border Is Not Necessary On The Proposed Asphalt Pavement.

ISSUED FOR CONSTRUCTION

Date: 9/1/15 BSM

LEGEND

	Proposed Ramp (4" AGHM Pavement P-401)
	Proposed Access Road (2" AGHM Pavement P-401)
	Exist. Asphalt Pavement
	Exist. Concrete Pavement
	Exist. Gravel
	Exist. Building
	Exist. Fence

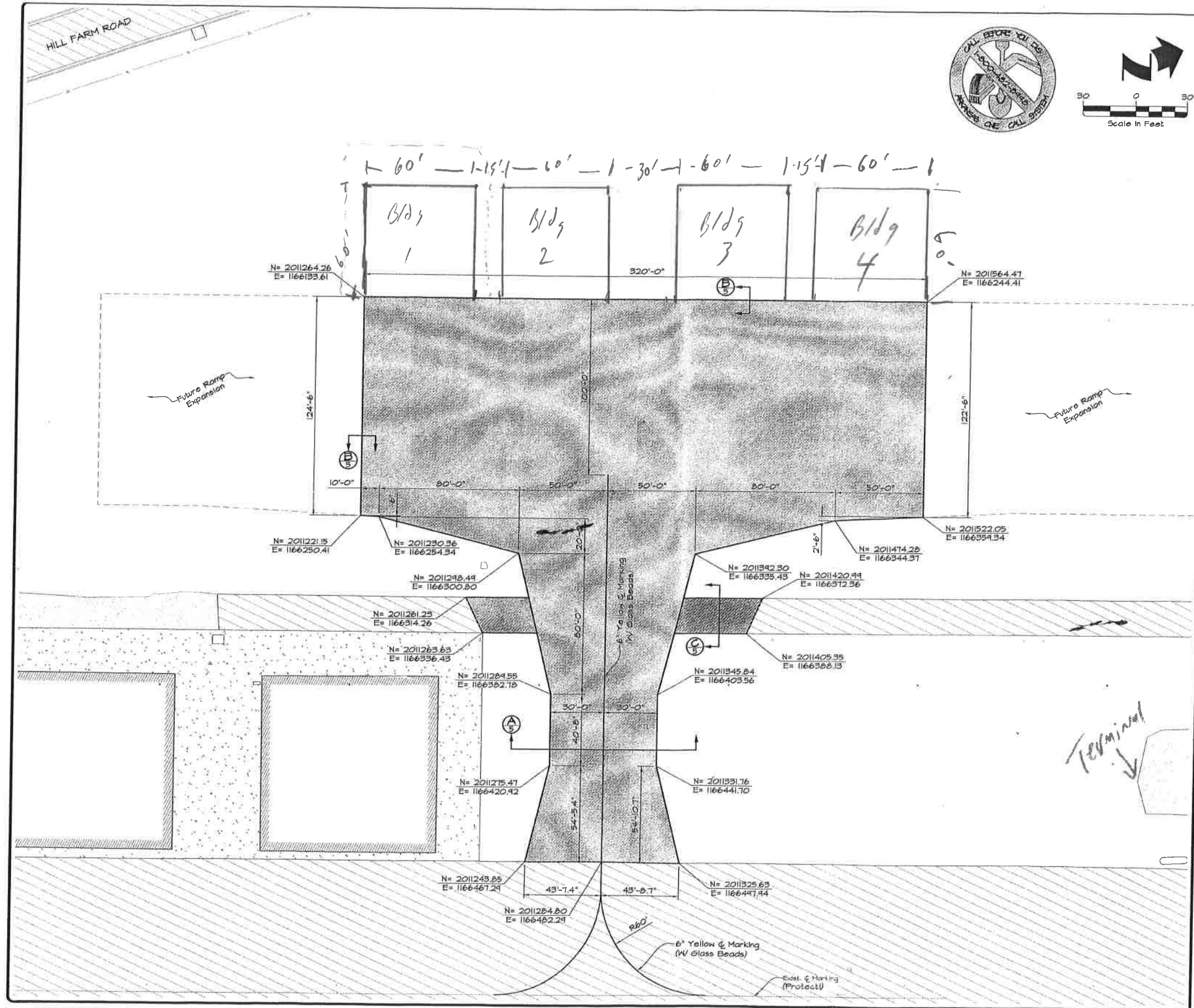

Revision	By	Date

MORRISON SHIPLEY
ENGINEERS ■ SURVEYORS
5704 Euper Lane, Suite 200 • Fort Smith, AR 72903 • 479.452.1933 • morrisonshipley.com

STATE OF ARKANSAS
BRIAN S. MAURER
LICENSED PROFESSIONAL ENGINEER
No. 10222
5/1/15

Drawn By: DRC
Approved By: BSM
Date: 5.01.15
Project No.: SAL-21 FAA

Vertical Scale: —
Horizontal Scale: 1"=30'
Plotting Scale: 1
Drawing Name: PLAN PAVING

HANGAR AREA RAMP EXPANSION
(FAA AIP No. 3-05-0090-008-2014)
Saline County Regional Airport

PAVING, SITE DIMENSION, and MARKING PLAN
Issued for Bidding - 5.01.15

Sheet No. **6** of **10**

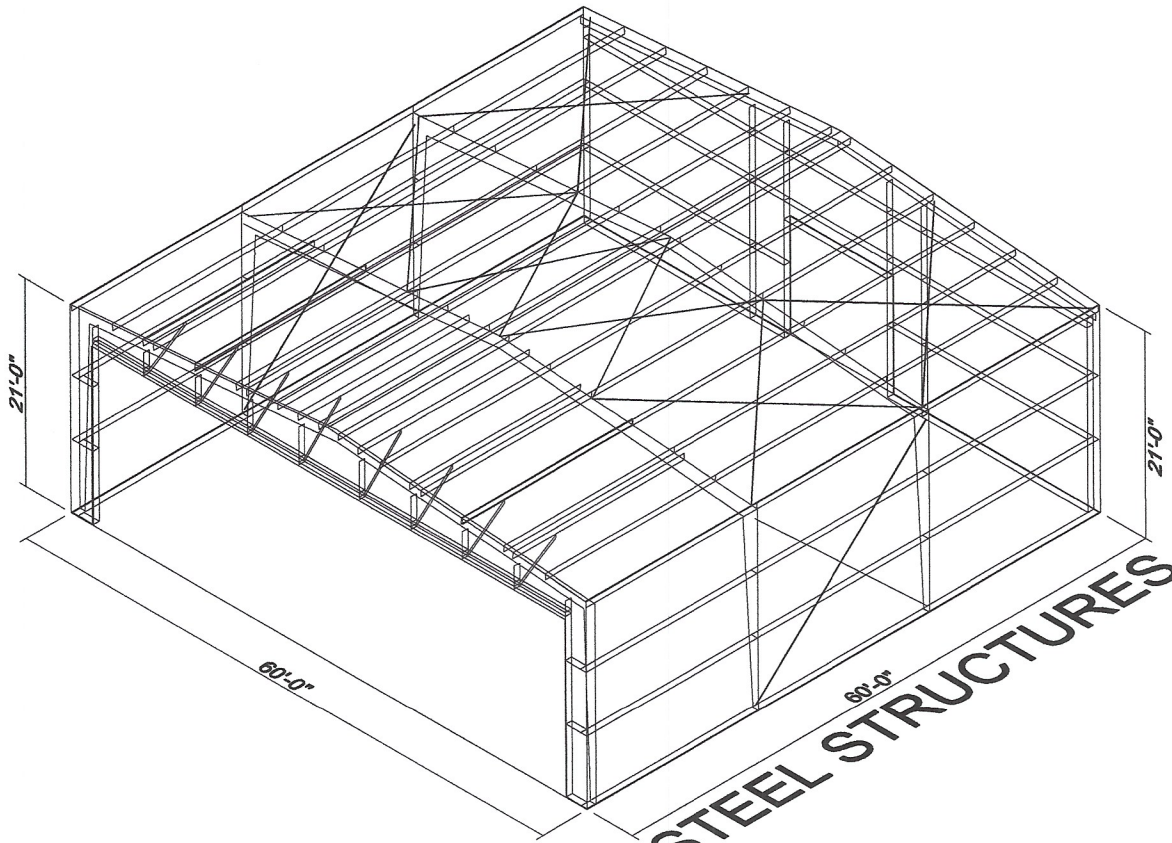

COWELL STEEL STRUCTURES, LLC