

SANITARY SEWER PROFILE

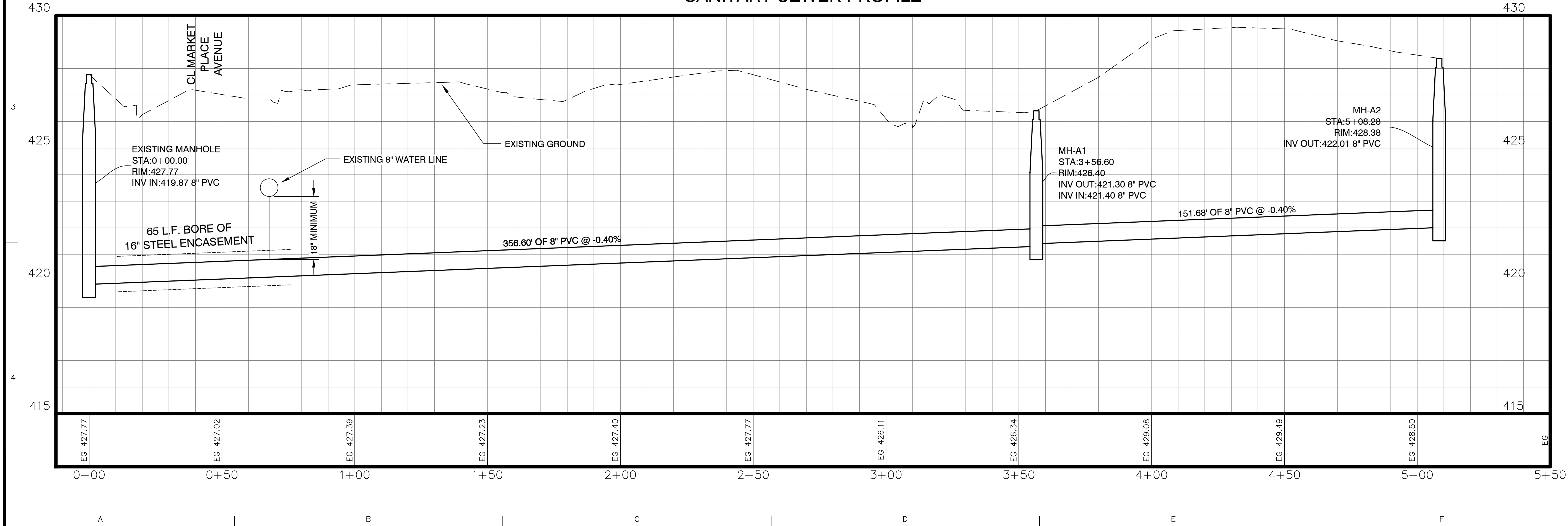

BY:	GPW
REVISION:	1. REVISED PER CITY OF BRYANT
DATE:	3-23-20

Designing our client's success

GNE GarNat Engineering, LLC
 3825 Mt Carmel Road
 Bryant, AR 72022
 garnatengineering@gmail.com

OFFSITE INFRASTRUCTURE IMPROVEMENTS BRYANT ORTHO CLINIC BRYANT, ARKANSAS



03-05-2020

CONTENTS:

GRAVITY SEWER PLAN & PROFILE

PROJECT NO:
20022

DATE:
MAR. 5, 2020

SHEET NO:
C2.0